

Contents

Important User Information	2	Introduction	6
Safety Precautions	3	Unpacking - First Time Set Up	7
Required Tools	3	System Set Up	8
Maintenance	3	Parts List	19
Ramp Systems with Turns and Switchbacks	4		
Ramp Systems without Turns and Switchbacks	5		



Visit the ADA Compliant Disability Ramp web page at wengercorp.com for more information.

Note: Please read and understand these instructions before proceeding.
Note: If you need additional information, contact Wenger Corporation using the information below.

Important User Information

General

Copyright © 2024 by Wenger Corporation

All rights reserved. No part of the contents of this manual may be reproduced, copied, or transmitted in any form or by any means including graphic, electronic, or mechanical methods or photocopying, recording, or information storage and retrieval systems without the written permission of the publisher, unless it is for the purchaser's personal use.

Printed and bound in the United States of America.

The information in this manual is subject to change without notice and does not represent a commitment on the part of Wenger Corporation. Wenger Corporation does not assume any responsibility for any errors that may appear in these instructions.

In no event will Wenger Corporation be liable for technical or editorial omissions made herein, nor for direct, indirect, special, incidental, or consequential damages resulting from the use or defect of these instructions. The manufacturer reserves the right to change this product at any time.

The information in this document is not intended to cover all possible conditions and situations that might occur. The end user must exercise caution and common sense when assembling or installing Wenger Corporation products. If any questions or problems arise, call the Wenger Corporation at (800) 4WENGER (493-6437) or +1-507-455-4100 worldwide.

Manufacturer

The ADA Compliant Disability Ramp is manufactured by:

Wenger Corporation
555 Park Drive
Owatonna, MN 55060
(800) 4WENGER (493-6437) • +1 (507) 455-4100
wengercorp.com

Intended Use

- This product is designed to be an accessibility ramp to a stage for individuals, performance groups and light equipment.
- This product is intended for indoor use in normal ambient temperature and humidity conditions — it must not be exposed to outside weather conditions.
- This product is intended to be assembled and used only as described in these instructions.

Warranty

Warranty information is available at wengercorp.com.

Safety Precautions

Throughout this document you may find cautions and warnings which are defined as follows:

- **WARNING:** Failure to follow the instruction could result in serious injury or damage to property.
- **CAUTION:** Failure to follow the instruction could result in minor injury or damage to property.

Read all of these safety instructions before using the equipment.

CAUTION

Make sure anyone assembling, installing or using this product has read and understands these instructions.

CAUTION

Failure to comply with Warnings and Cautions in this document or on the equipment can result in damage to property or injury.

Required Tools

- Tape measure
- 6' Carpenter's level
- Mallet
- 7/32" Allen wrench
- 5/32" Allen wrench
- 9/16" Combination wrench or socket and ratchet
- 15/16" Leveler wrench
- Pipe wrench
- A digital level is recommended

Maintenance

Decks

Keep the deck surfaces clean and dry. When necessary, clean with a broom or brush.

No other maintenance is required. Do not use oil-based cleaning products, and do not wax or polish the decks.

Preventative Maintenance

Inspect all hardware and knobs on the system and accessories every six months, and tighten as necessary.

Replace any worn, bent, or broken parts promptly to prevent injury.

Ramp Systems with Turns and Switchbacks

NOTICE

Typical layout shown below for example purposes only.
 Components, quantities and configurations will vary depending on actual layout.
 See the separate set up guide for specifics, the attached labels identify the components.

Item	Description	Item	Description	Item	Description
1	Approach Section	8	LH Outside Approach Rail	23	Switchback Bracket
		9	RH Inside Approach Rail	24	Ramp to Deck Connector
2	Switchback Down Deck	10	LH Outside Switchback Down Rail	25	Two Leg Deck Connector
		11	RH Inside Switchback Landing Down Rail	26	Leg (various sizes)
3	Switchback Down Deck	12	LH Switchback Down Rail	27	Rail Pocket
		13	LH Switchback Landing Rail		
		14	RH Switchback Inner Rail		
4	Switchback Up Deck	15	LH Switchback Landing Up Rail		
5	Switchback Up Deck	16	LH Outside Switchback Up Rail		
		17	RH Inside Switchback Up Rail		
6	Landing Up Deck	18	LH Outside Landing Up Rail		
		19	RH Inside Landing Up Rail		
7	Landing Deck	20	LH Turn Top Landing Rail		
		21	RH Landing Down Rail		
		22	RH No Turn Top Landing Rail		

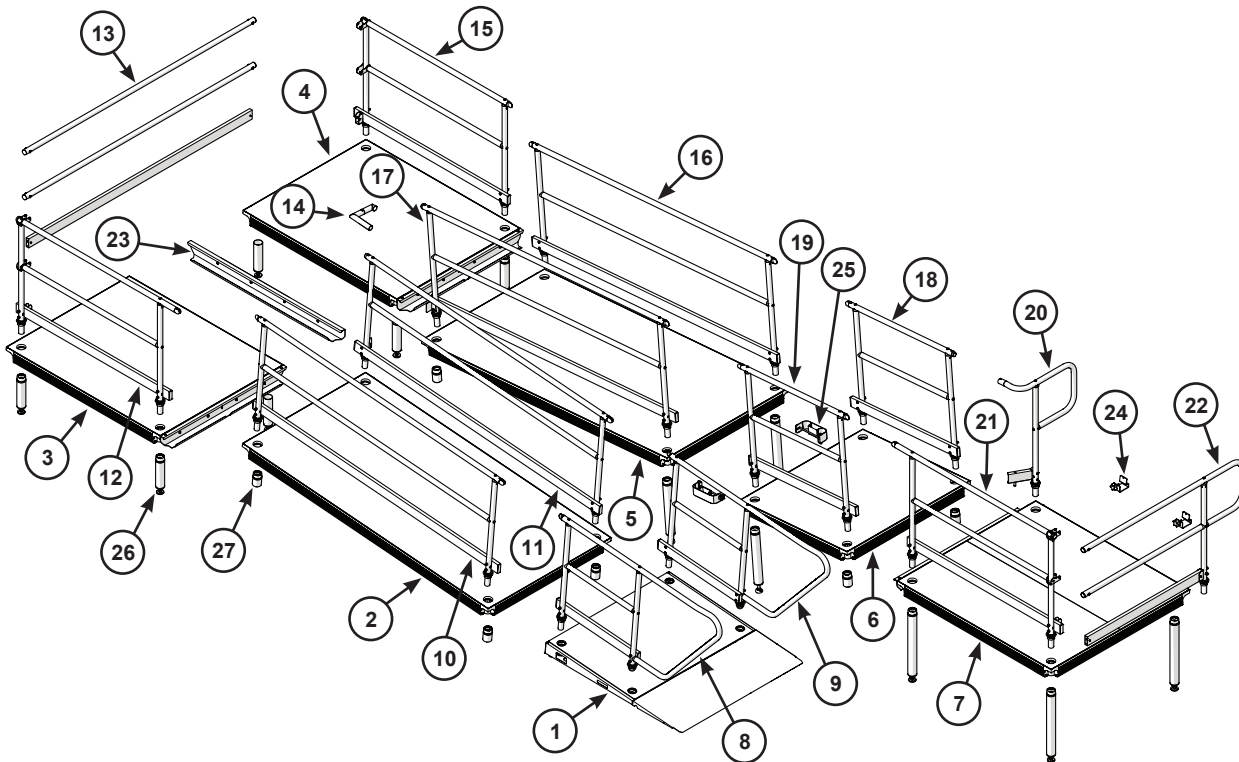

Shown with optional mid rails

Ramp Systems without Turns and Switchbacks

NOTICE

Typical layout shown below for example purposes only.
 Components, quantities and configurations will vary depending on actual layout.
 See the separate set up guide for specifics, the attached labels identify the components.

Item	Description	Item	Description	Item	Description
1	Approach Section	3	LH Approach Rail	7	Leg (various sizes)
		4	RH Approach Rail	8	Deck Down Bracket
2	Landing Up Deck	5	LH No Turn Ramp to Stage Rail		
		6	RH No Turn Ramp to Stage Rail		

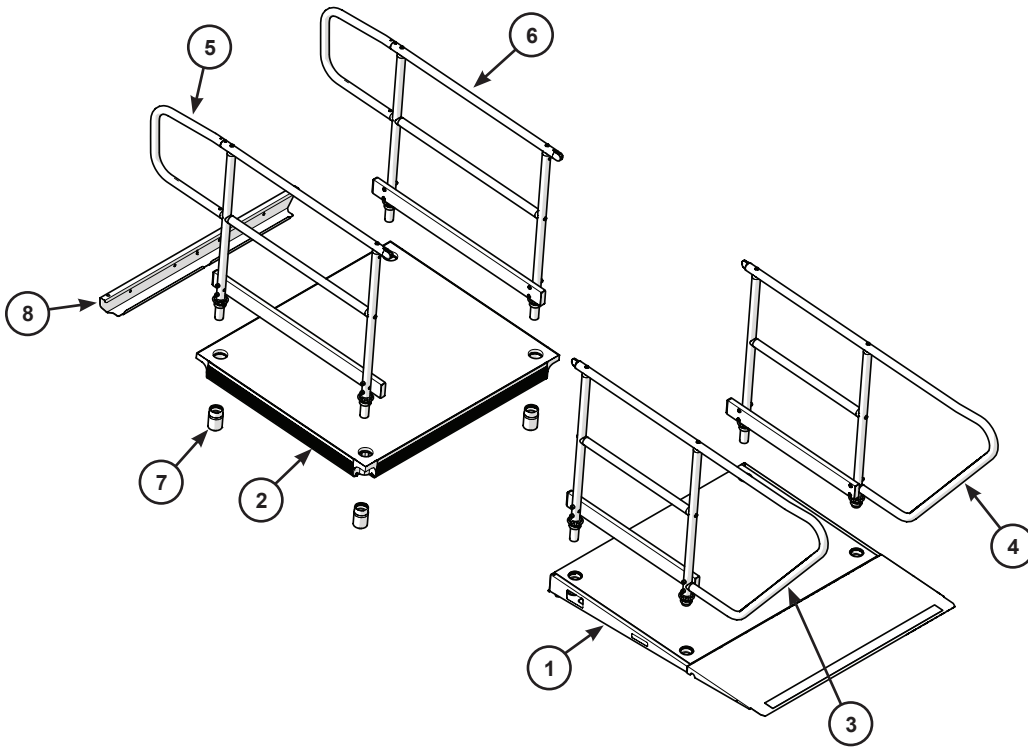

Shown with optional mid rails

Introduction

NOTICE

Included with each ADA ramp configuration is a component set up guide for that application showing which components are needed and in what order they are installed

Save the set up guide for future use!

The set up guide is laminated and may be attached to the underside of the top deck

Americans with Disabilities Act

(U.S. Code IBC 2012, Section 1010)

The ADA Ramp is designed to fully comply with ADA guidelines for providing access to platforms.

The Americans with Disabilities Act (ADA) is a revolutionary piece of civil rights legislation that guarantees any person with a qualified disability equal access to all areas of public accommodations and to the programs and activities held in public buildings. This legislation has far-reaching implications for making staging, risers, and audience and performer seating accessible to persons with these disabilities.

The ADA is explicit in its guidelines for ramps, including the degree of slope and the requirement for a continuous gripping surface on the entire length of the handrail.

Other state and local coded may apply.

Ramp Slope

The ADA allows a maximum 1:12 ramp slope (4.76°).

The ADA Ramp accommodates ramp slopes up to 1:12, and also allows for slight adjustment needed to account for floor variations.

Landings

The ADA Ramp allows a maximum height change of 30" (762 mm) before a landing is required.

Your ramp may include one or more landings to comply with this requirement.

Height Adjustments

Height should be matched to the nominal ramp height at each leg location. Refer to the set up guide that was supplied with the ADA Ramp.

The leg heights shown on the drawing may have to be adjusted slightly to correct for any irregularities in the floor. Height lock nuts are provided to lock the height adjustments.

Introduction (continued)

Deck Variations

The ADA ramp system is available in a variety of configurations, heights and deck and ramp sizes. Custom configurations are available.

Leg Variations

Leg heights can be adjusted by turning the foot and setting the height lock nut located above the foot.

Flat Foot Leg for landing decks.

Swivel Foot Leg for incline decks.

Leg without Insert for deck leg locations that do not attach to uprights.

Deck top surfaces will not have a hole at these locations.

Rail Pocket for deck locations that do not have legs and are bridged together by brackets.

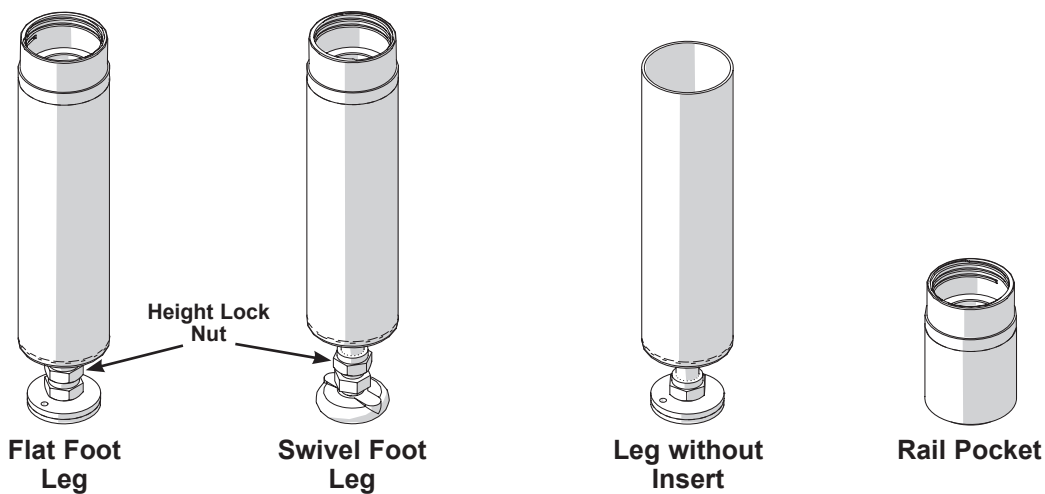

Unpacking - First Time Set Up

⚠ CAUTION

To avoid damage and injury, more than one person is needed for installation.

1. **Read and understand the complete assembly procedure before beginning set up. It is recommended to unpack the items according to the order of assembly.**
2. Remove all parts from the shipping cartons (refer to the packing list for the shipment). Save the packaging materials until the system has been completely set up the first time.
3. Sort all accessories by order of assembly.

System Set Up

NOTICE

Rail and deck assemblies are detailed in the "Parts List" pages at the end of these instructions. Components, quantities and configurations will vary depending on actual layout. See the separate set up guide for specifics, the attached labels identify the components.

NOTICE

The sequence and specifics of this System Set Up procedure may vary depending upon system configuration.

To set up the ADA ramp, start at the highest deck and work down toward the bottom approach section. The layout order is indicated by the labels on the components and on the set up guide.

1. Attach legs and rail pockets into each of the deck corner pockets as indicated by the set up guide. Every deck corner pocket should receive a leg or rail pocket.
 - a. Insert the leg or rail pocket all of the way into each of the deck corner pockets.
 - b. Secure each by hand tightening the knob on every deck corner pocket. No tools are required.
 - c. Turn the deck right-side up.
 - d. Deck heights can be adjusted by turning the height adjustment nut as described in "Leg Variations".

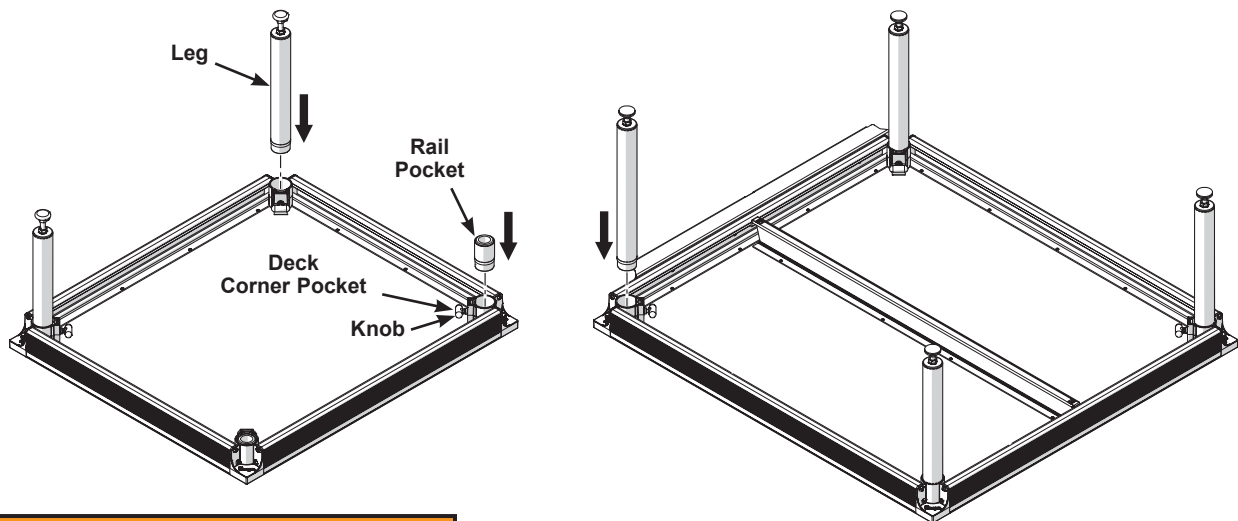

⚠ WARNING

Deck assemblies can be unstable if the legs are not properly attached.

System Set Up (continued)

2. Connect the highest deck to the existing staging system.

Be sure that the existing stage is level and that the height is the same as the specified height of the ADA ramp. All railings should already be installed on the existing stage.

Be sure that the ramp surfaces are flush to avoid trip hazards.

For straight on ramps systems that do not turn
(See next page for ramp systems that do turn):

- Using the included hardware, attach the deck down bracket to the adjacent deck.
Use the longer socket screws when attaching to a Versalite deck.
Holes may need to be drilled into the deck to mount the bracket.
- Lift the ADA deck to sit on the deck down bracket.

Connecting to a StageTek® Deck

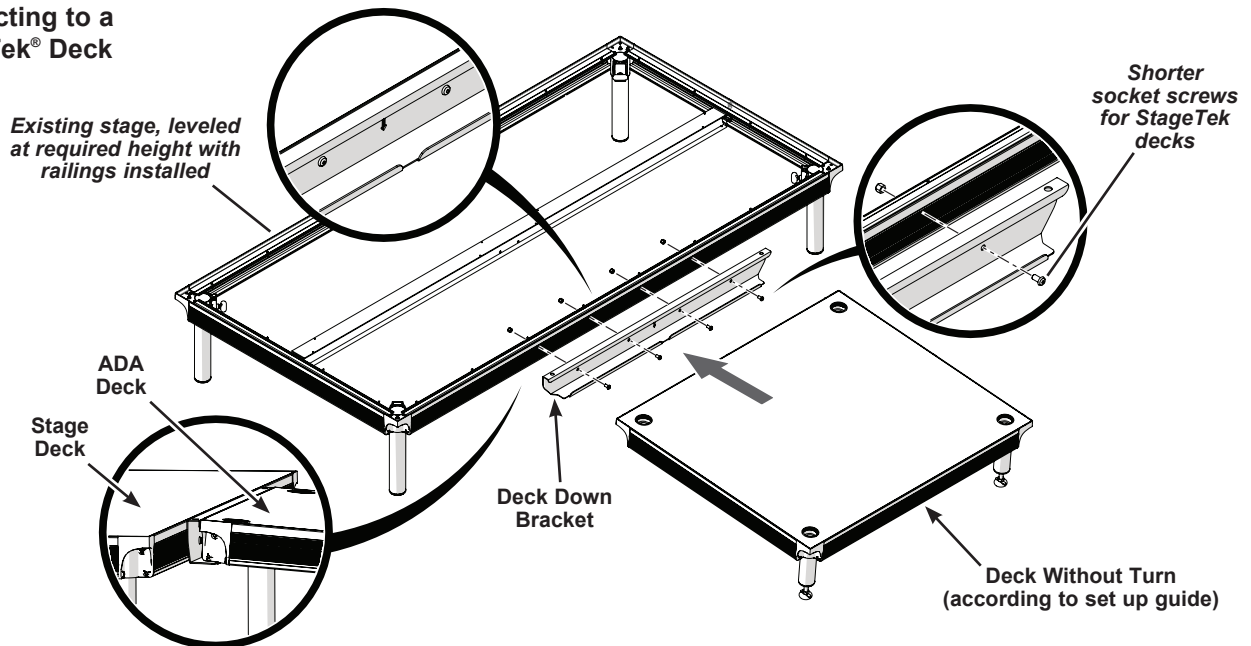

Connecting to a Versalite® Deck

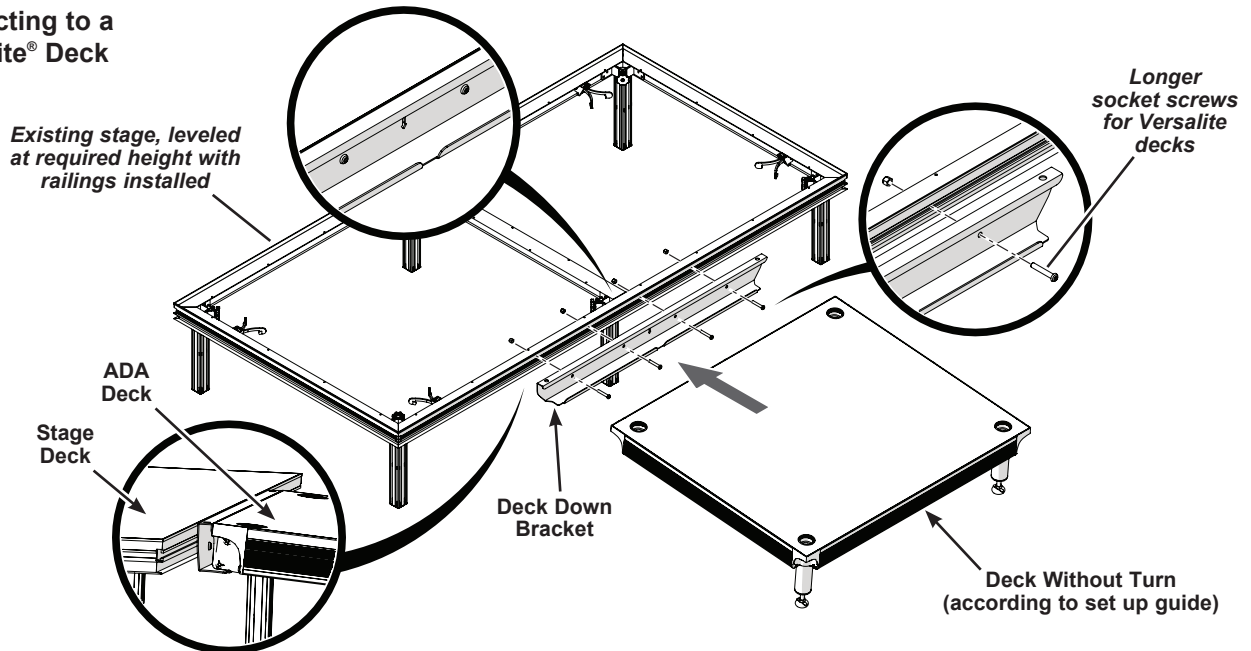

System Set Up (continued)

2. (continued) For ramp systems that do turn:

- According to the set up guide, fit the first deck against the edge of the adjoining stage deck.
- Fit one ramp to deck connector under the frame extrusions of the stage deck and ADA deck near each edge as shown.
- If necessary, adjust the ADA deck height to be even with the existing stage.
- Tighten the handle on both connectors to secure the deck into place.

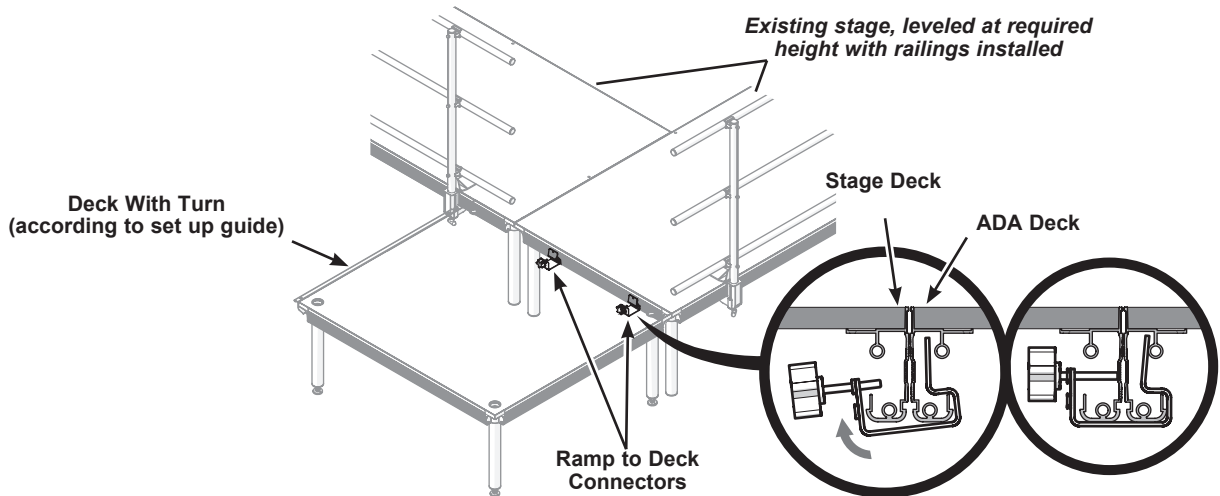

- If the deck has a deck bracket attached, lift the next deck to sit on the bracket. An arrow on the deck bracket will indicate the slope direction of the next deck.

Be sure that adjoining deck surfaces are flush to avoid trip hazards.

NOTICE

Deck bridging provides a building code required transition between slope changes and adjacent decks.

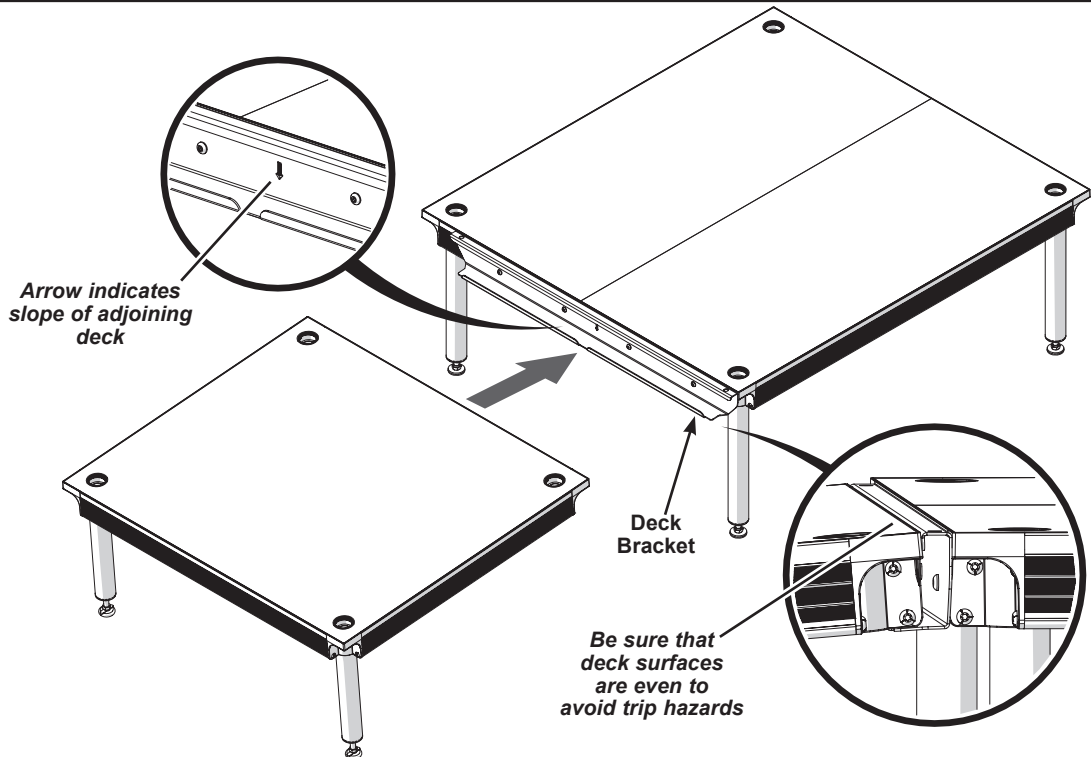

System Set Up (continued)

4. If the deck does not have a deck bracket attached, position the next deck to be flush and secure in place with two leg deck connectors.

The opposite side of the deck may need to be elevated or secured in place before the connectors can be attached.

For best stability, attach the connectors as high up on the legs as possible.

- a. With the flat side facing out, fit the connector over both legs.
- b. Attach the connector to each leg by closing the bolt and securing the wing nut.

⚠ WARNING

The ADA ramp system is unstable unless all adjoining decks are connected.

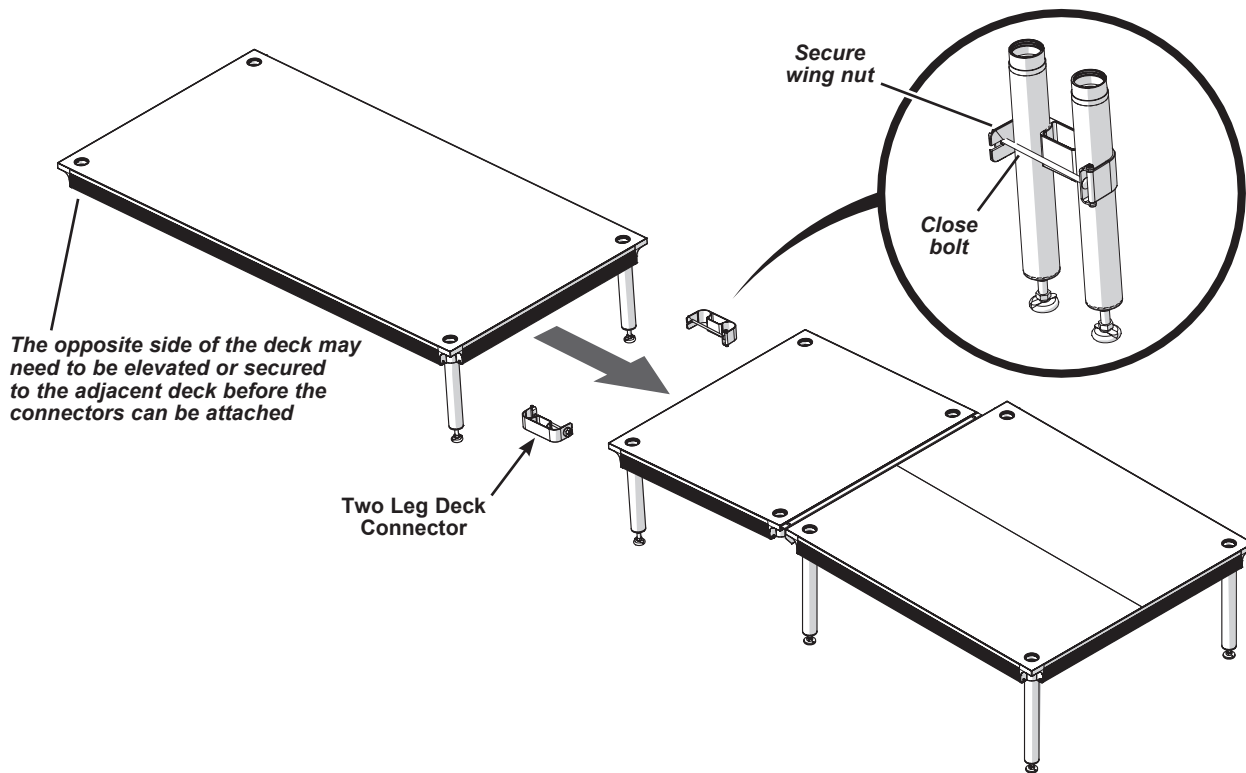

System Set Up (continued)

5. Where two switchback decks are to be connected, a switchback bracket must be attached to one deck.
 - a. Using the included hardware, attach the switchback bracket to the deck frame extrusion that has pilot holes.
 - b. Lift the next switchback deck to sit on the switchback bracket.
Be sure that the deck surfaces are flush to avoid trip hazards.
6. Continue adding any remaining decks according to the set up guide.

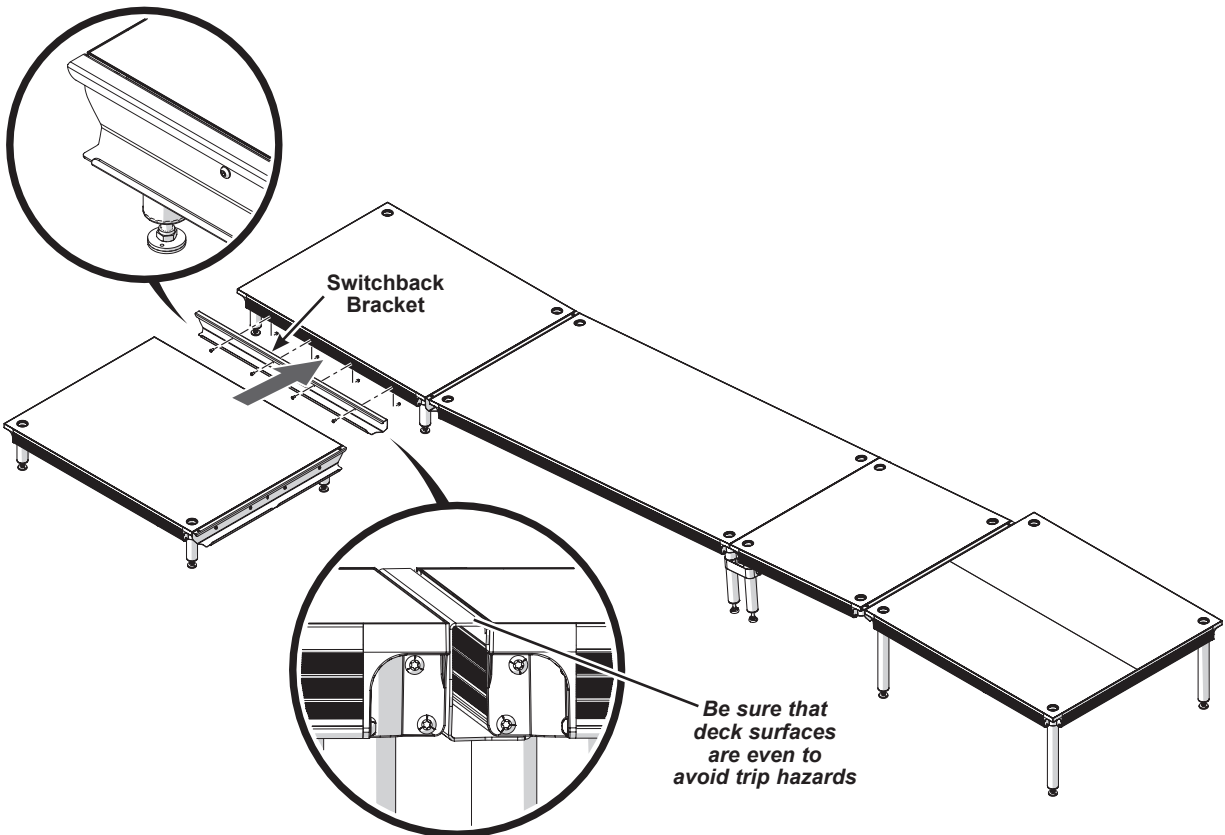

System Set Up (continued)

7. Attach the approach section to the lowest deck.
 - a. Slide the tabs at the back of the bottom approach weldment to fit under the lowest deck.
 - b. Lay the top approach weldment to fit onto the tabs of the bottom approach weldment.

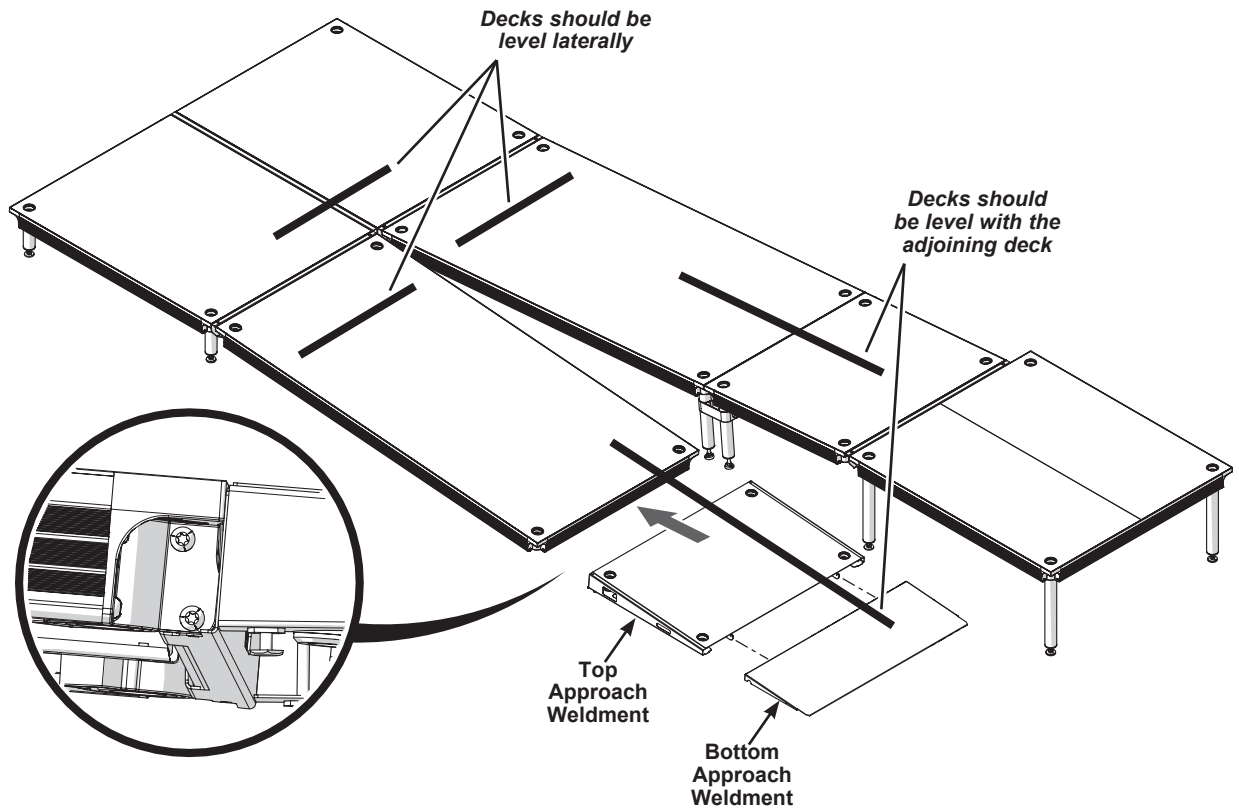

System Set Up (continued)

8. Attach the pre-assembled approach rails to the approach section.
See the "Parts List" and following pages for more details.
 - a. Insert the uprights into the holes of the approach section.
 - b. Loosely tighten the upright hold down nuts into the approach section.
9. Attach and assemble the landing rails to the landing deck.
The landing rails are packaged separately but must be assembled, see the "Parts List" and following pages for more details.

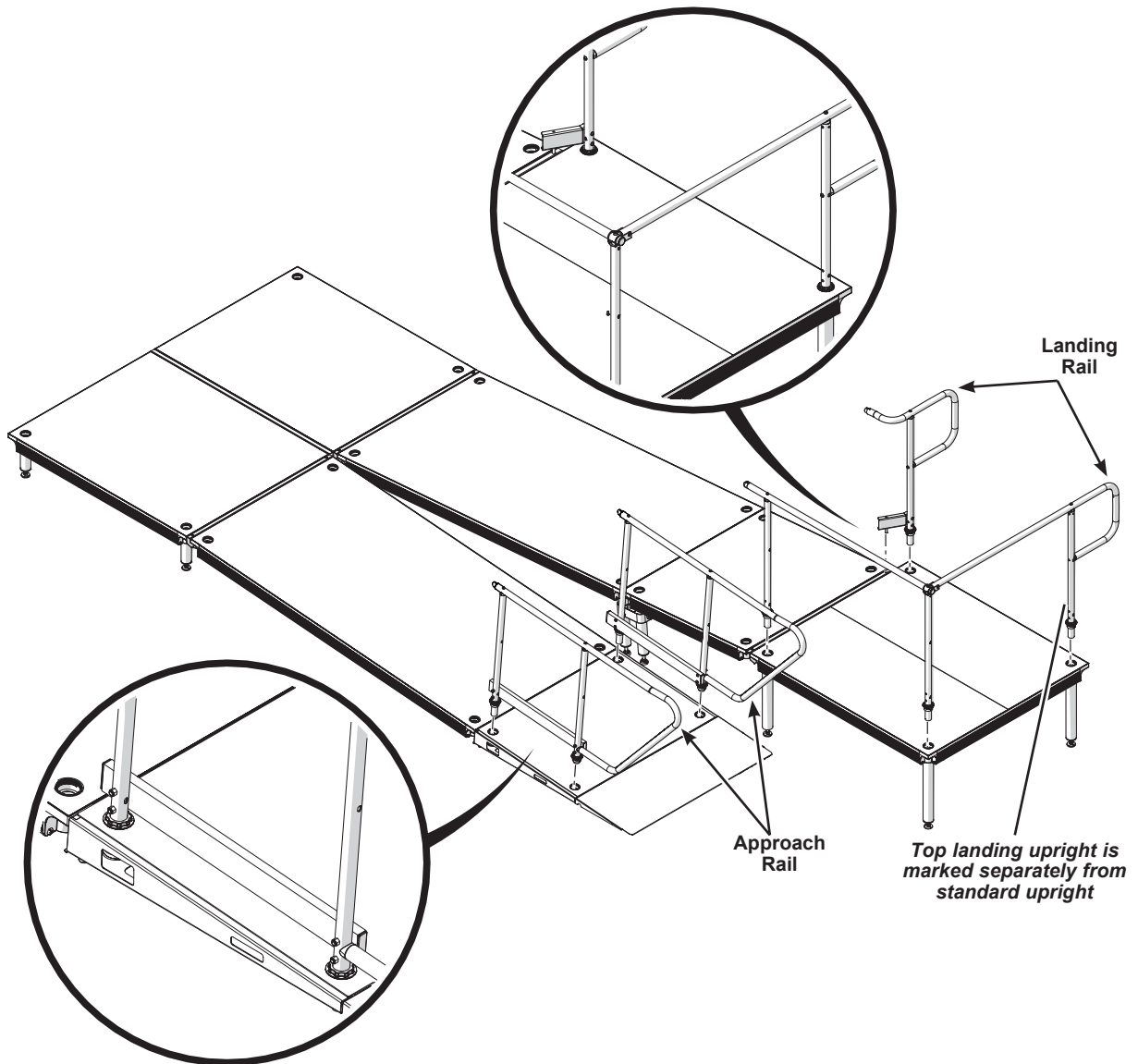

System Set Up (continued)

10. Insert uprights into the remaining holes in the decks according to the set up guide and parts list.
 - a. Orient the bottom holes of the uprights toward the deck to receive toe kicks in the following step.
 - b. Slide one upright hold down nut onto each upright and loosely tighten it to the deck.

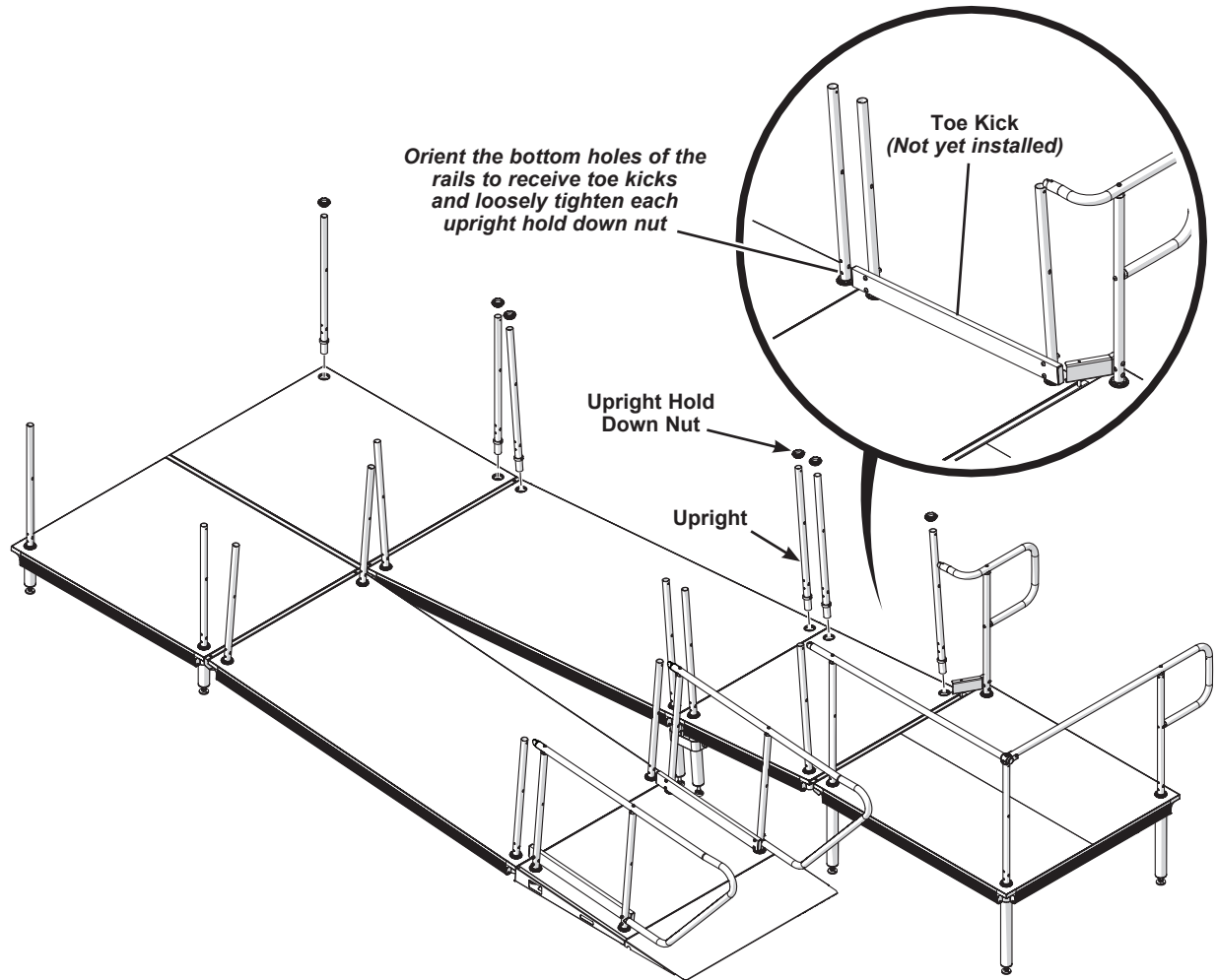

System Set Up (continued)

11. Attach all of the toe kick brackets and toe kicks to the inside of the uprights according to the set up guide and parts list.

Toe kicks and brackets may not be used on all configurations.

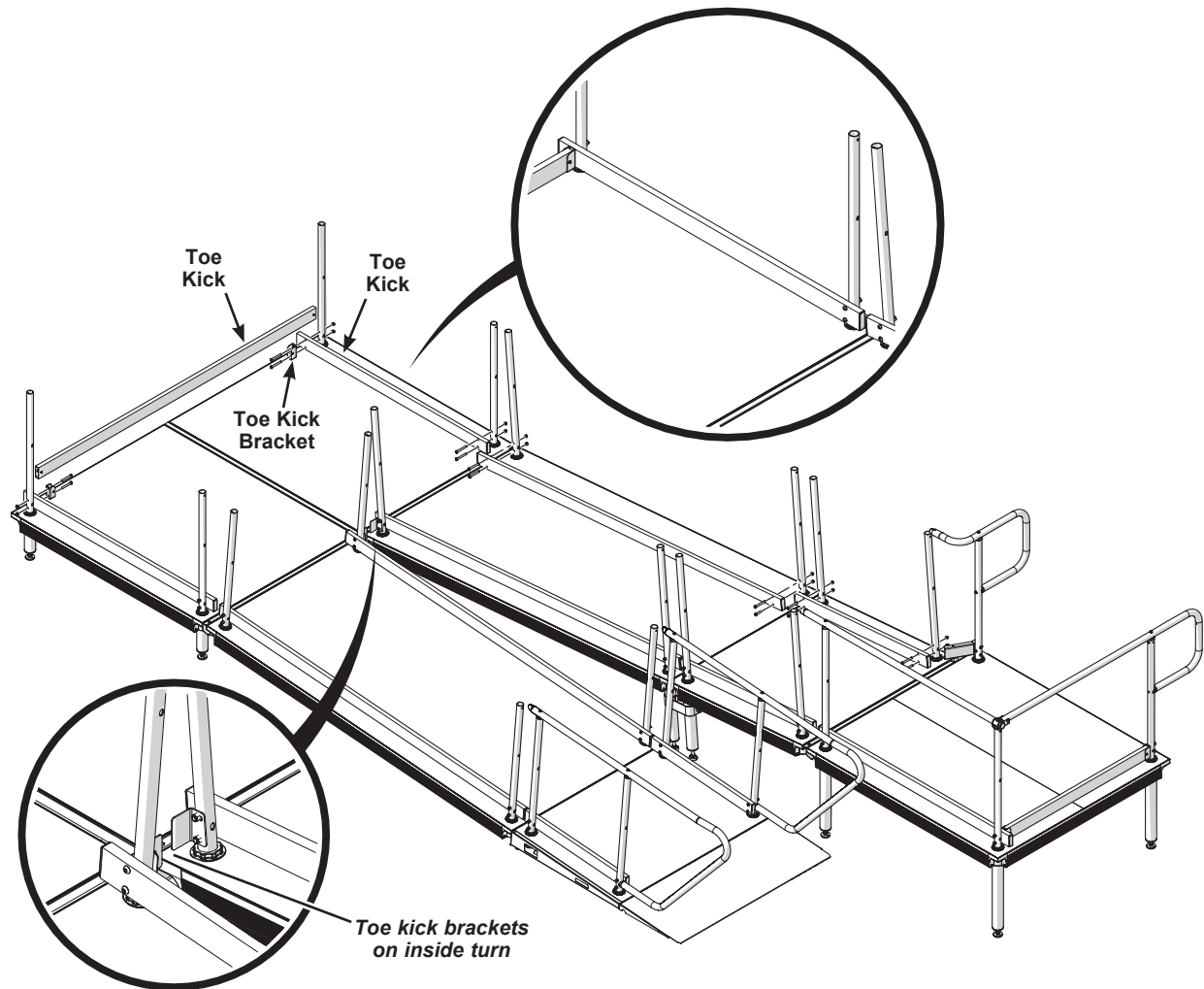

System Set Up (continued)

12. If installing the optional mid rails, attach them and any brackets to the inside of the upright, approach and landing rails according to the set up guide and parts list.

If mid rails are not being installed, skip ahead to the following step.

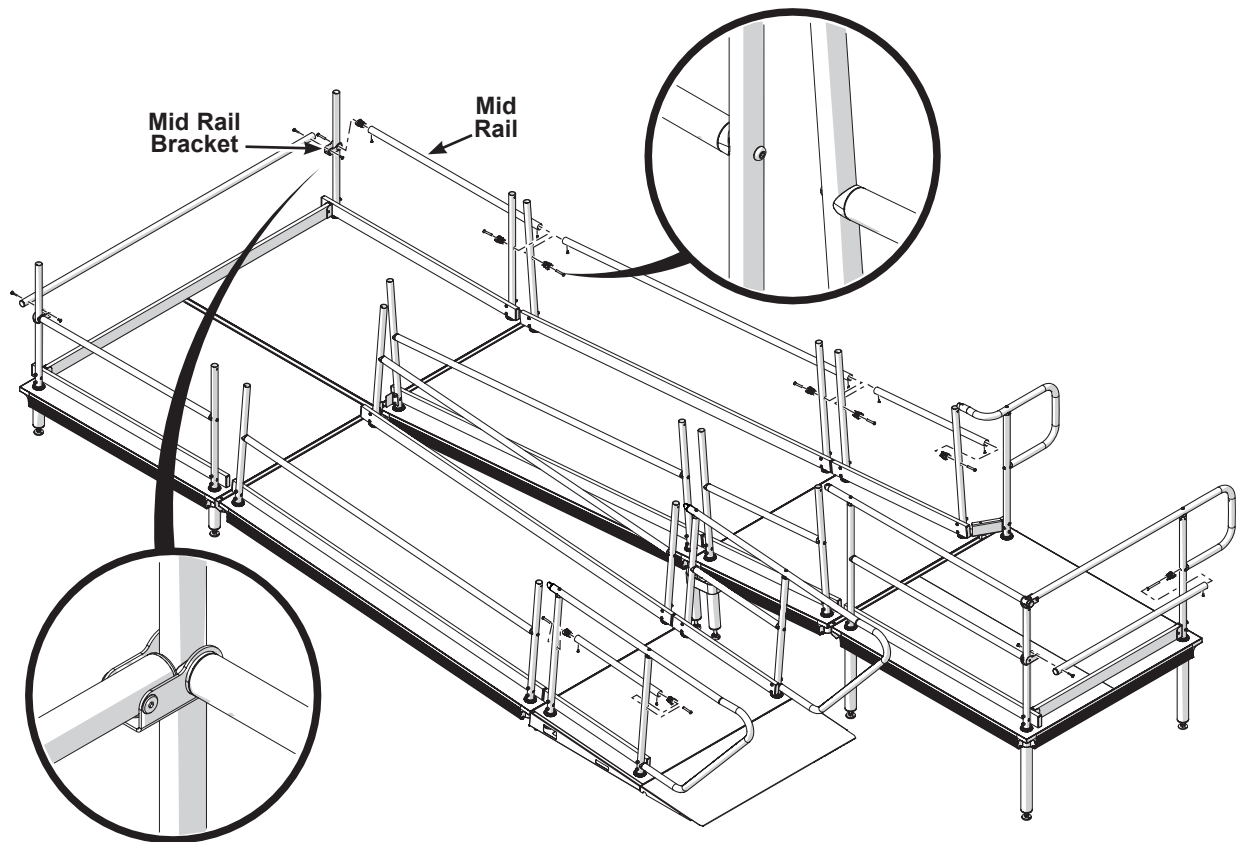

System Set Up (continued)

13. Attach the top rails to the tops of the uprights according to the set up guide and parts list.
The tabbed end of the top rail will always be at the highest elevation of the rail.

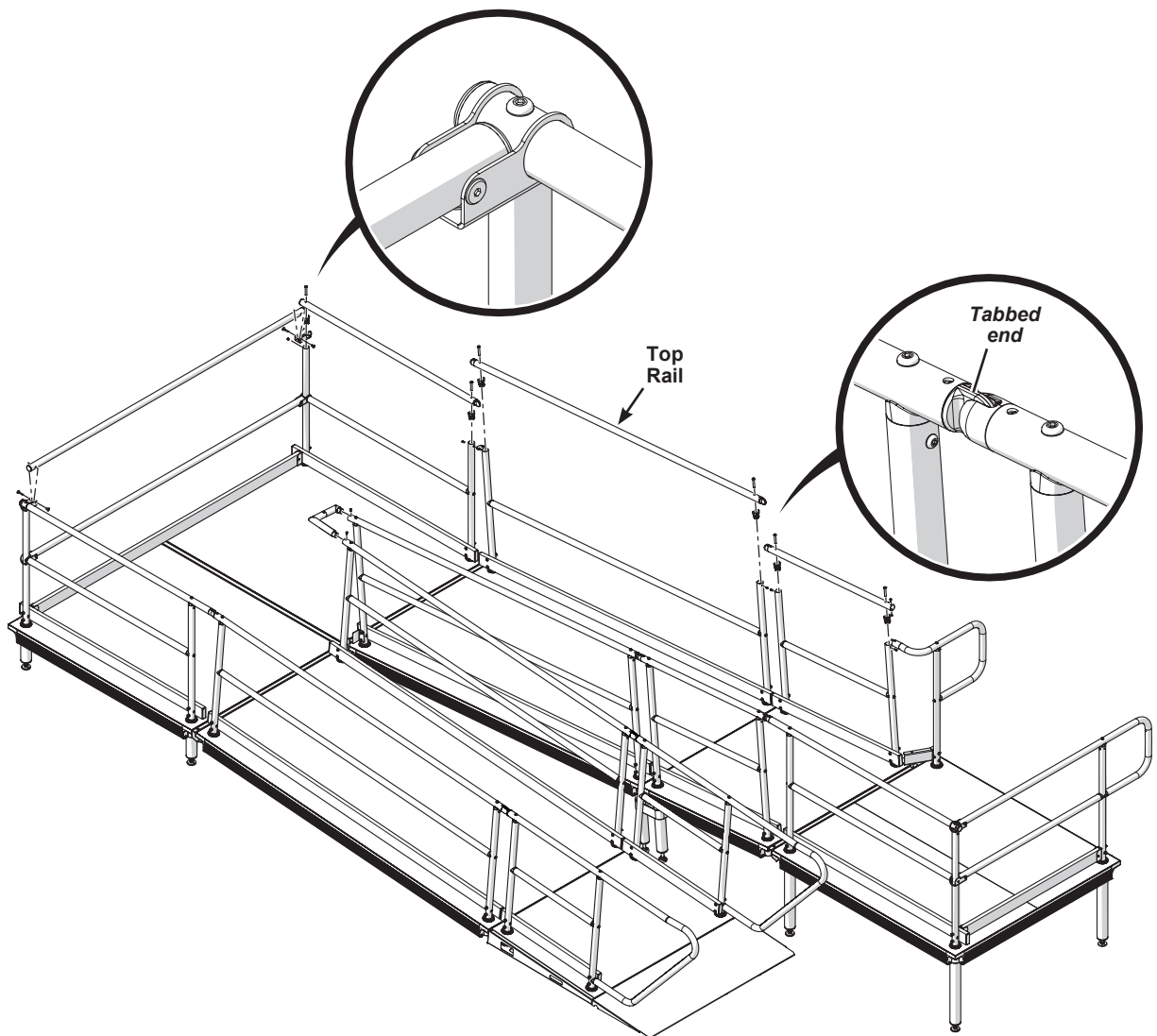

14. Tighten all of the rail hardware.
For added stability, tighten the upright hold down nuts with a pipe wrench.

Parts List

Approach Rails (ships fully assembled, without optional mid rails)

Item	Description	Item	Description	Item	Description
1	Upright	6	90 Degree Connector	11	1/4-20 x 1/2" Socket Screw
2	Approach Upright	7	Toe Kick Tube	12	Mid Rail Tube (Optional)
3	Upright Hold Down Nut	8	1" x 3" Plug		
4	Approach Tube Rail	9	3/8-16 x 3" Socket Screw		
5	3/8-16 x 2" Socket Screw	10	3/8-16 Lock Nut		

*Used with optional mid rail only

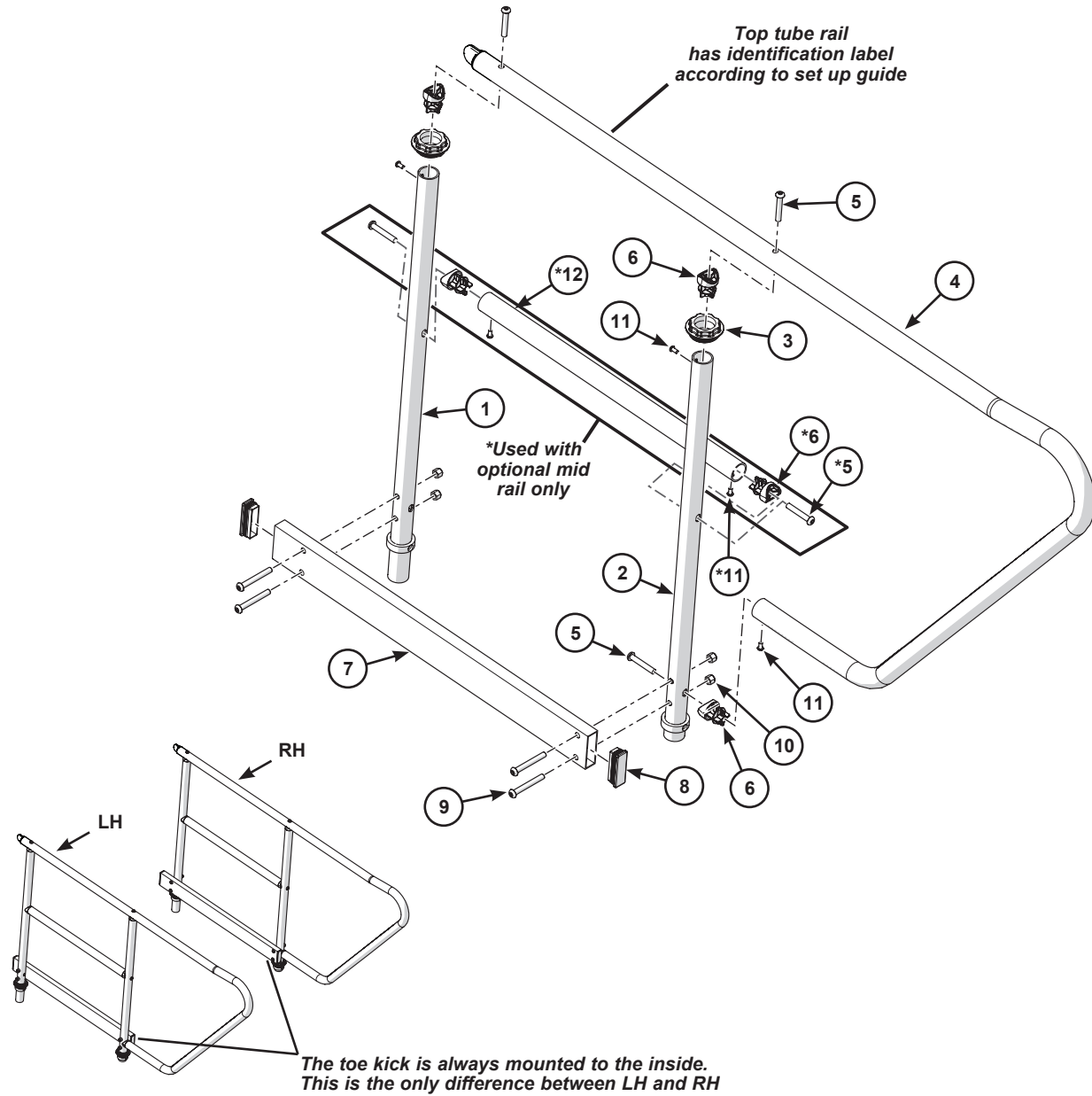

Part List (continued)

Switchback Up/Down Rails

Item	Description	Item	Description	Item	Description
1	Upright	6	Toe Kick Tube	11	Mid Rail Tube (Optional)
2	Upright Hold Down Nut	7	1" x 3" Plug	12	Switchback Top Rail Bracket
3	Top Tube Rail	8	3/8-16 x 3" Socket Screw	13	Switchback Mid Rail Bracket
4	90 Degree Connector	9	3/8-16 Lock Nut		
5	3/8-16 x 2" Socket Screw	10	1/4-20 x 1/2" Socket Screw		

*Used with optional mid rail only

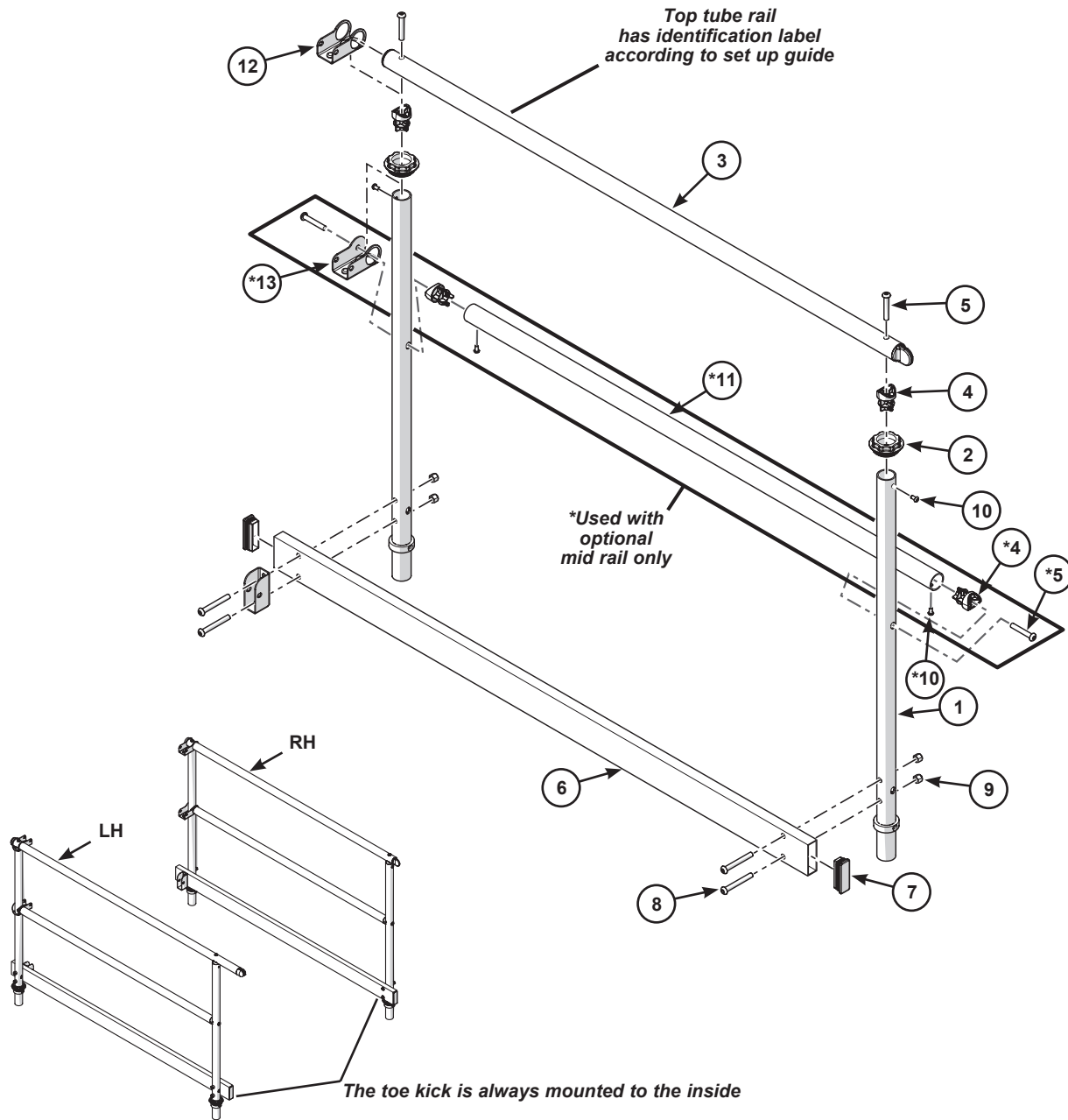

Part List (continued)

Turn Top Landing Rail

Item	Description	Item	Description	Item	Description
1	Upright	6	1/4-20 x 1/2" Socket Screw	11	1/4-20 Lock Nut
2	Upright Hold Down Nut	7	3/8-16 Lock Nut		
3	Top Landing Tube Rail	8	Toe Kick Top Landing Bracket		
4	90 Degree Connector	9	0.50 OD x 0.25 ID x 1.50 Spacer		
5	3/8-16 x 2" Socket Screw	10	1/4-20 x 2" Socket Screw		

*Top tube rail
has identification label
according to set up guide*

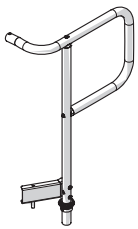
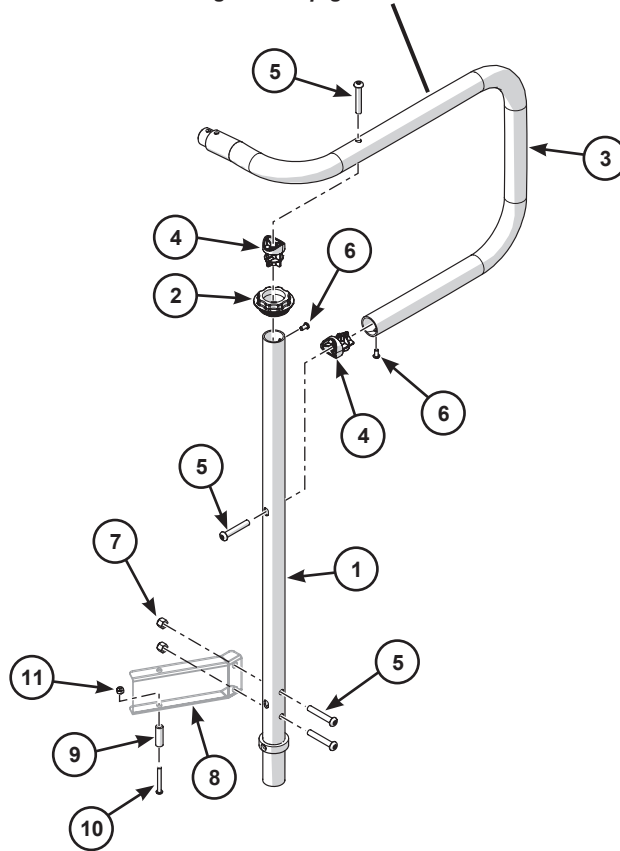

Part List (continued)

Landing Down Rails

Item	Description	Item	Description	Item	Description
1	Upright	6	Toe Kick Tube	11	Mid Rail Tube (Optional)
2	Upright Hold Down Nut	7	1" x 3" Plug	12	Switchback Top Rail Bracket
3	Top Tube Rail	8	3/8-16 x 3" Socket Screw	13	Switchback Mid Rail Bracket
4	90 Degree Connector	9	3/8-16 Lock Nut	14	Toe Kick Receiver Bracket
5	3/8-16 x 2" Socket Screw	10	1/4-20 x 1/2" Socket Screw		

*Used with optional mid rail only

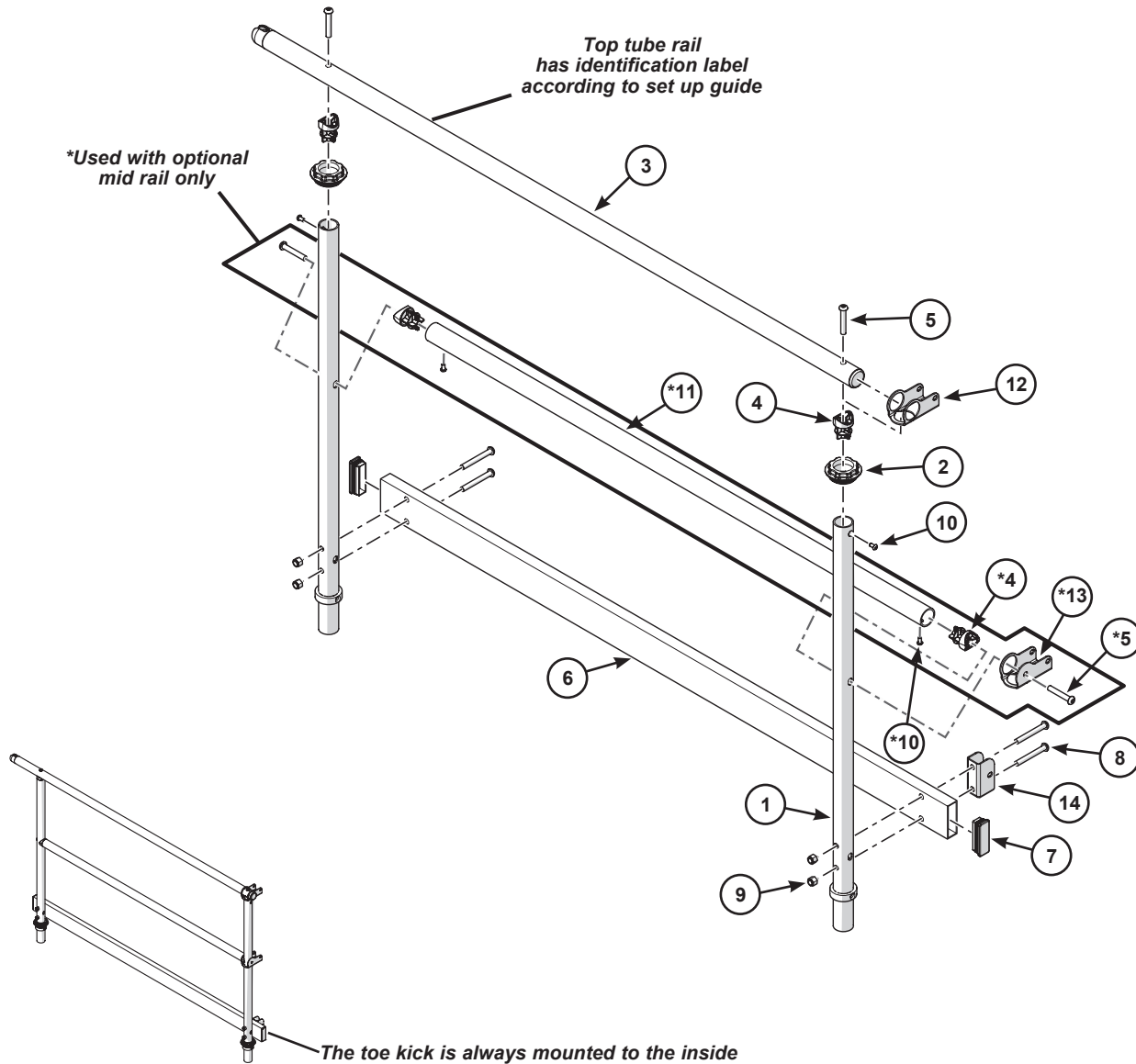

Part List (continued)

No Turn Top Landing Rail

Item	Description	Item	Description	Item	Description
1	Top Landing Upright (marked separately)	6	Toe Kick Tube with Snap Buttons	11	1/4-20 Cap Nut
2	Upright Hold Down Nut	7	3/8-16 Lock Nut	12	Mid Rail Tube (Optional)
3	Top Landing Tube Rail	8	1/4-20 x 1/2" Socket Screw	13	3/8-16 x 3-1/2" Socket Screw
4	90 Degree Connector	9	1.50 OD Plug	14	Toe Kick Receiver Bracket
5	3/8-16 x 2" Socket Screw	10	1/4-20 x 1.575 Machine Screw	15	3/8-16 x 2-1/4" Socket Screw

*Used with optional mid rail only

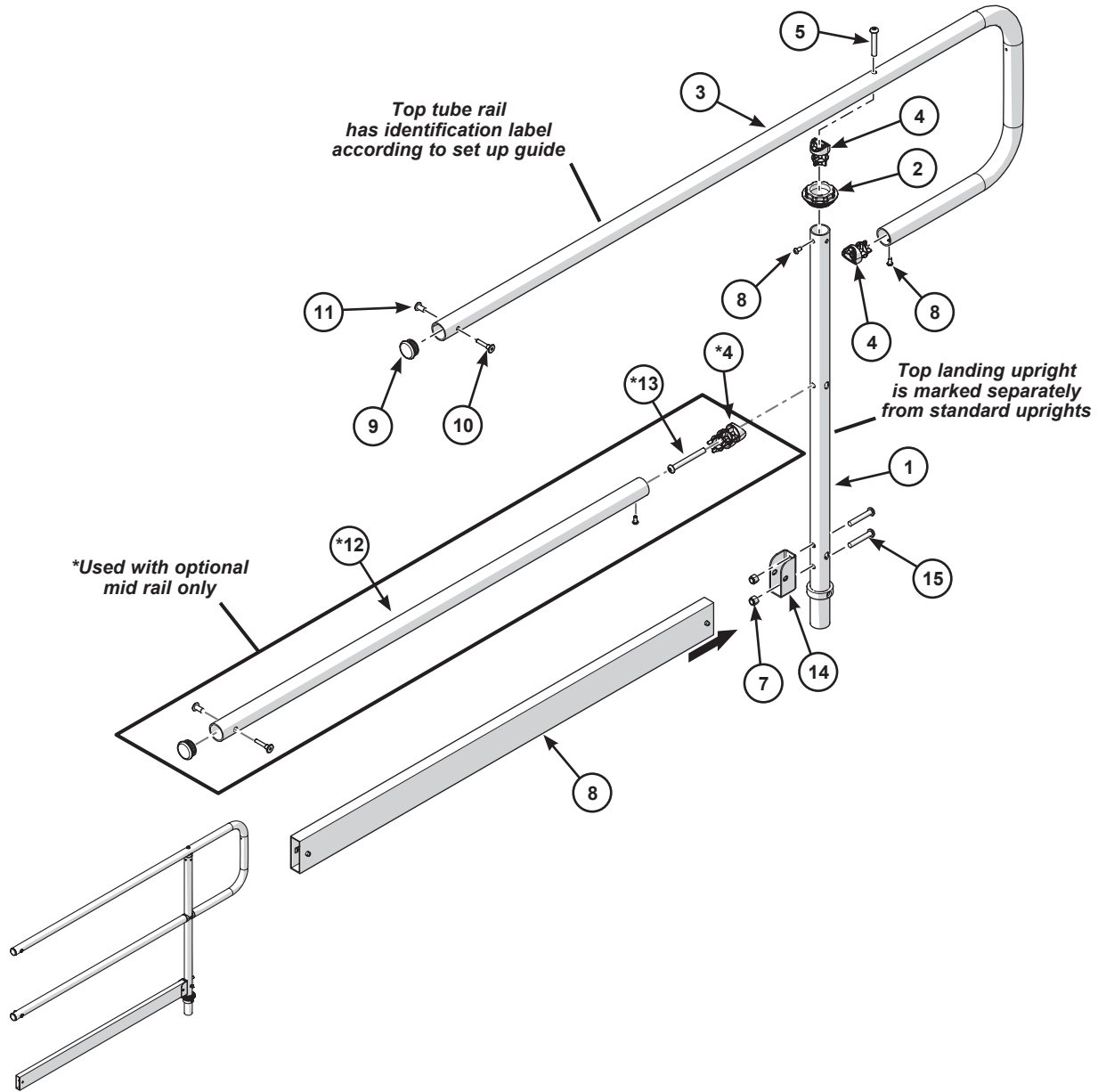

Part List (continued)

No Turn Ramp to Stage Rails

Item	Description	Item	Description	Item	Description
1	Upright	6	1" x 3" Plug	10	90 Degree Connector
2	Upright Hold Down Nut	7	3/8-16 x 3" Socket Screw	10a	90 Degree Connector (Bored-Out)
3	Straight-On Tube Rail	8	3/8-16 Lock Nut	11	3/8-16 x 2" Socket Screw
4	1/4-20 x 1/2" Socket Screw	9	Top Tube Rail	12	Mid Rail Tube (Optional)
5	Toe Kick Tube			13	3/8-16 x 3-1/2" Socket Screw

*Used with optional mid rail only

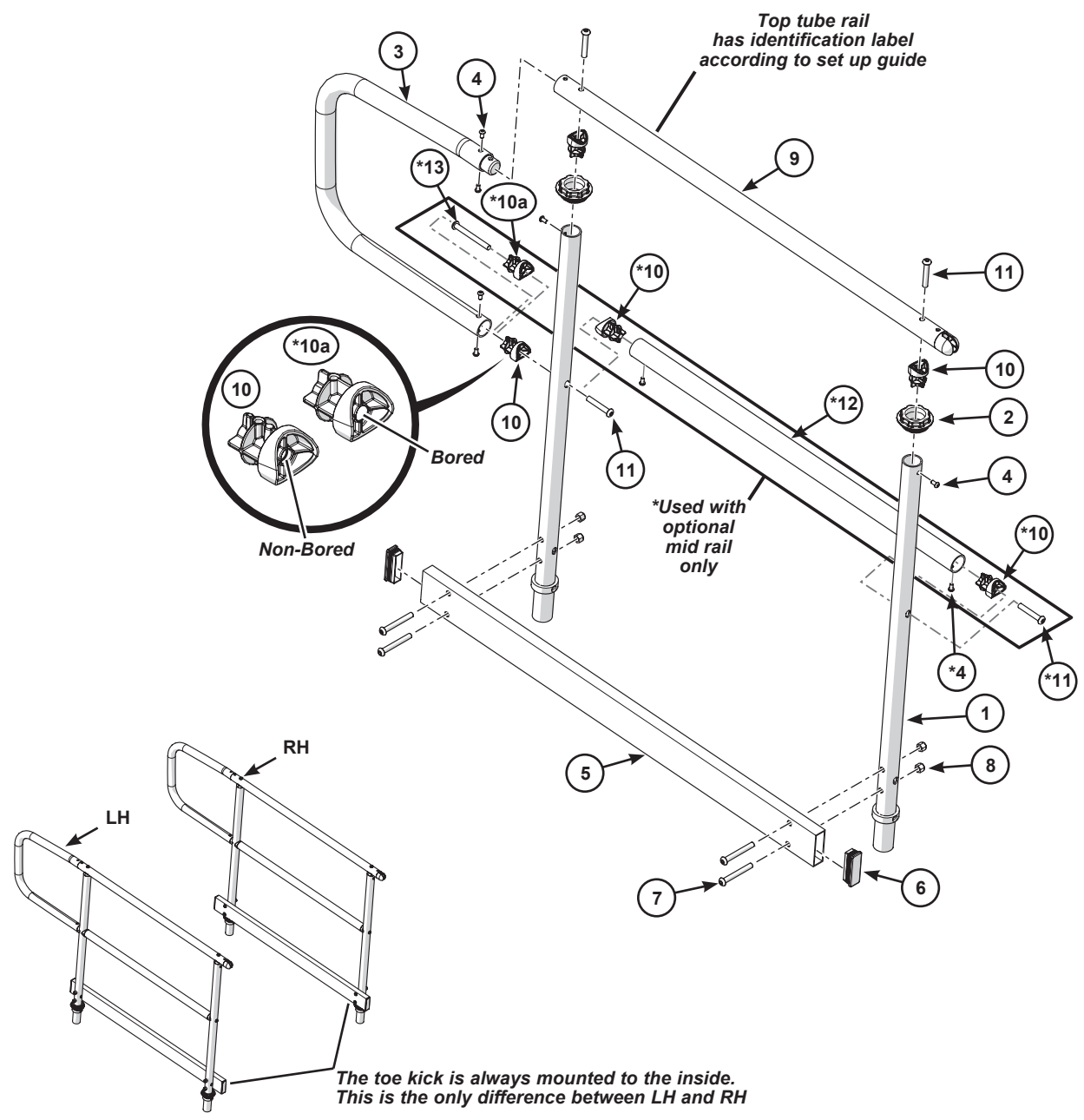

Part List (continued)

Switchback Down Rails

Item	Description	Item	Description	Item	Description
1	Upright	6	Toe Kick Tube	11	Mid Rail Tube (Optional)
2	Upright Hold Down Nut	7	1" x 3" Plug	12	Switchback Toe Kick Bracket
3	Top Tube Rail	8	3/8-16 x 3" Socket Screw		
4	90 Degree Connector	9	3/8-16 Lock Nut		
5	3/8-16 x 2" Socket Screw	10	1/4-20 x 1/2" Socket Screw		

*Used with optional mid rail only

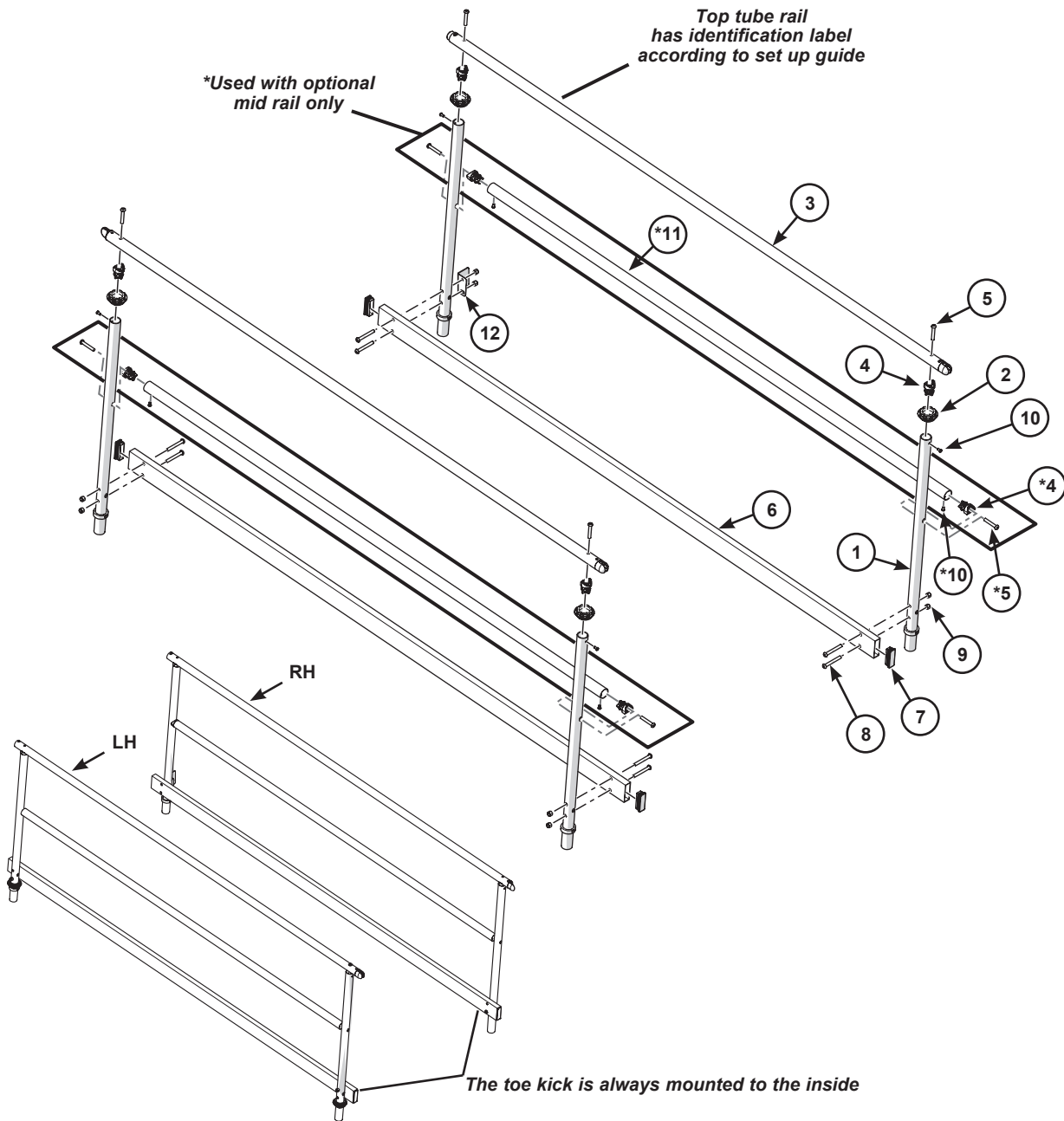

Part List (continued)

Switchback Up Rails

Item	Description	Item	Description	Item	Description
1	Upright	6	Toe Kick Tube	11	Mid Rail Tube (Optional)
2	Upright Hold Down Nut	7	1" x 3" Plug	12	Switchback Toe Kick Bracket
3	Top Tube Rail	8	3/8-16 x 3" Socket Screw		
4	90 Degree Connector	9	3/8-16 Lock Nut		
5	3/8-16 x 2" Socket Screw	10	1/4-20 x 1/2" Socket Screw		

*Used with optional mid rail only

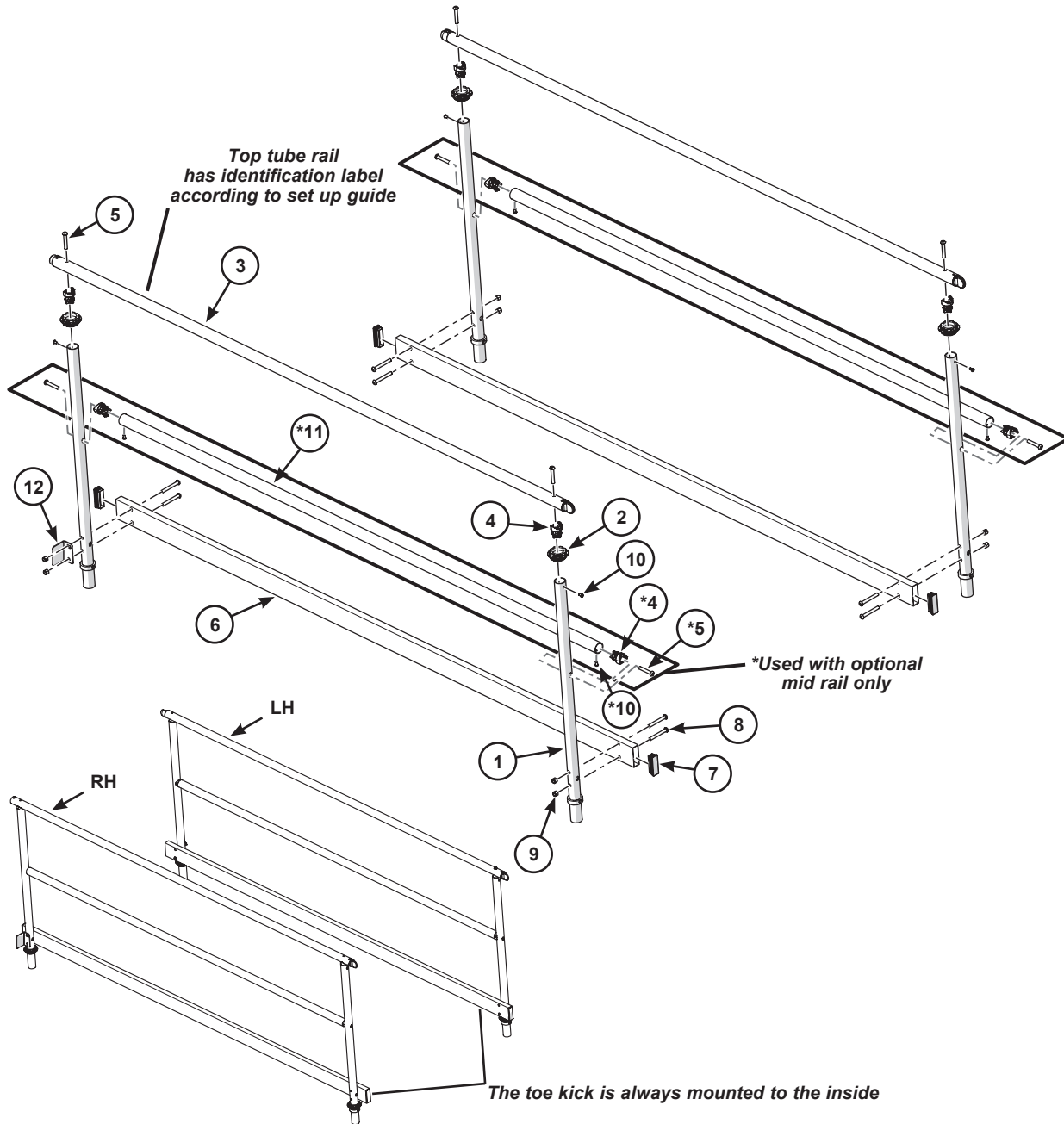

Part List (continued)

Landing Up Rails

Item	Description	Item	Description	Item	Description
1	Upright	6	Toe Kick Tube	11	Mid Rail Tube (Optional)
2	Upright Hold Down Nut	7	1" x 3" Plug		
3	Top Tube Rail	8	3/8-16 x 3" Socket Screw		
4	90 Degree Connector	9	3/8-16 Lock Nut		
5	3/8-16 x 2" Socket Screw	10	1/4-20 x 1/2" Socket Screw		

*Used with optional mid rail only

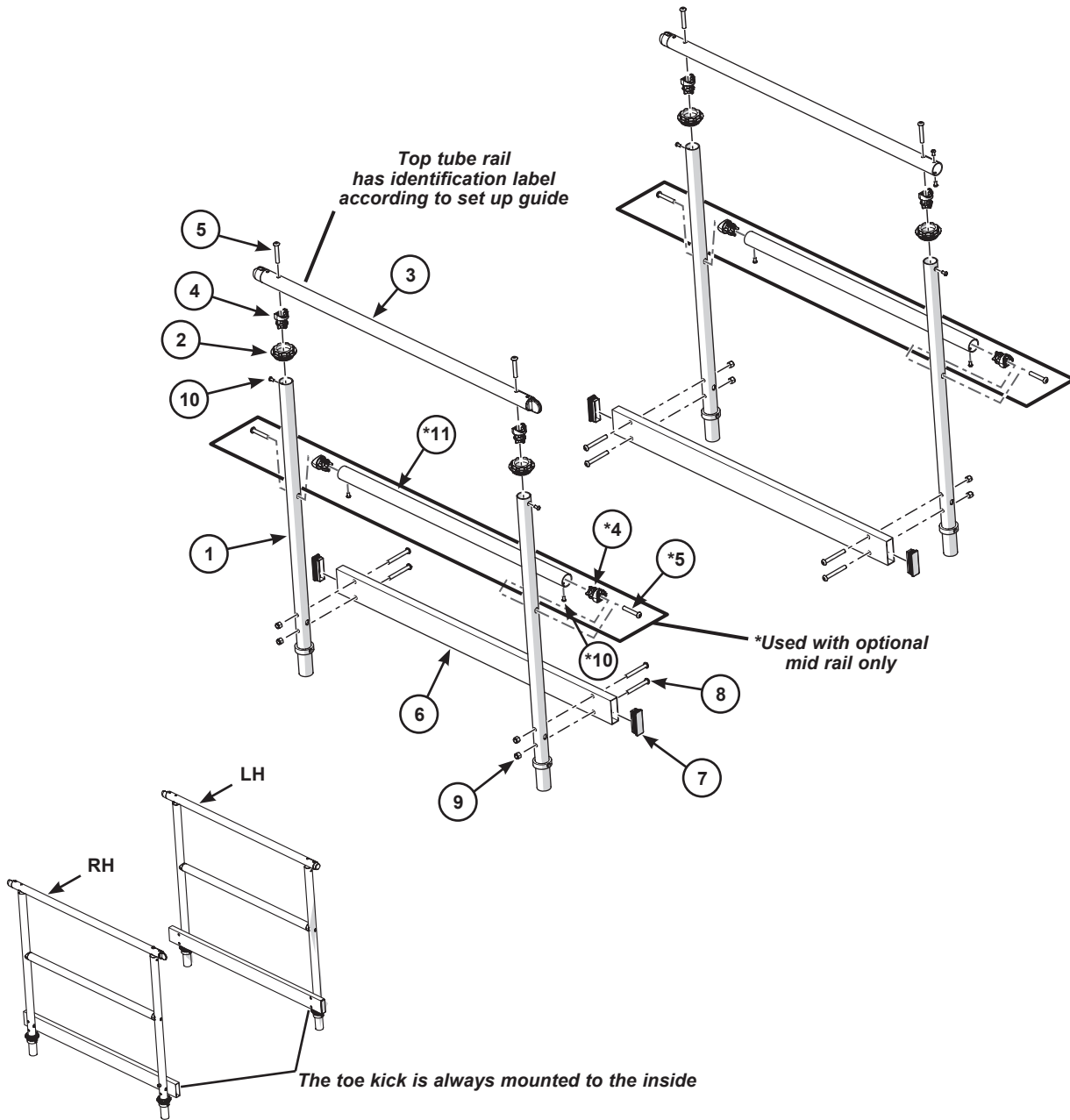

Part List (continued)

Switchback Landing Rail

Item	Description	Item	Description	Item	Description
1	Top Tube Rail	3	1.50 OD Plug	5	1/4-20 Cap Nut
2	Toe Kick Tube with Snap Buttons	4	1/4-20 x 1.575 Machine Screw	6	Mid Rail Tube (Optional)

*Used with optional mid rail only

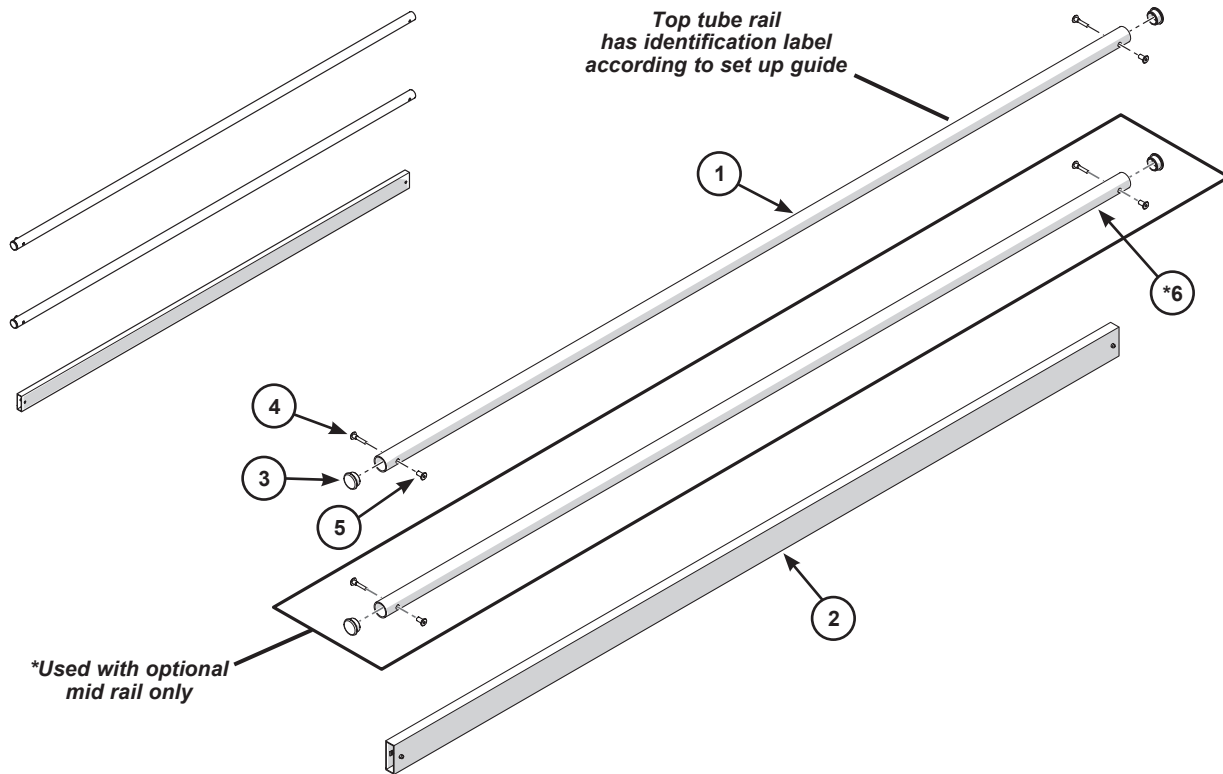

Switchback Inner Rail

Item	Description	Item	Description	Item	Description
1	Inside Weldment Switchback Tube AB	2	Inside Weldment Switchback Tube CD	3	1/4-20 x 1/2" Socket Screw

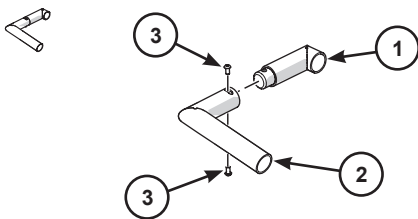

Part List (continued)

Landing Deck

Item	Description	Item	Description
1	Deck Surface	6	Deck Down Bracket
2	90° Corner Pocket Assembly	7	Deck Up Bracket
3	3/8-16 x 1-1/4" Torque Screw	8	Switchback Bracket
4	Deck Frame Extrusion	9	3/8-16 Lock Nut
5	#10-16 x 3/4" Pan Head Screw	10	3/8-16 x 3/4" Socket Screw

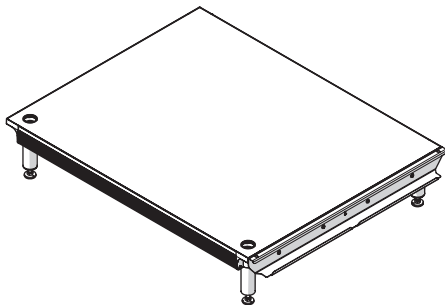
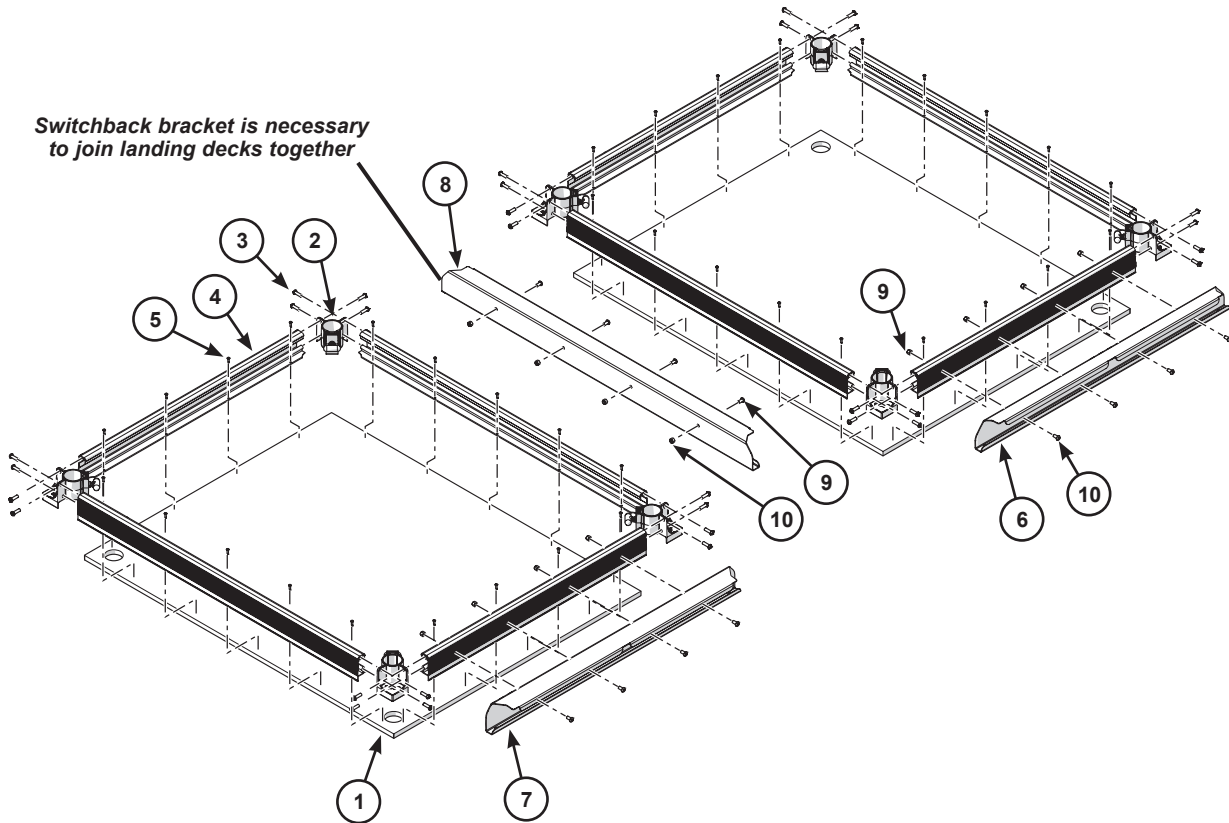

Part List (continued)

Incline Deck

Item	Description	Item	Description
1	Deck Surface	5	#10-16 x 3/4" Pan Head Screw
2	90° Corner Pocket Assembly	6	Mid Rail Brace
3	3/8-16 x 1-1/4" Torque Screw	7	Mid Rail Connect Extrusion
4	Deck Frame Extrusion	8	3/16 Blind Rivet

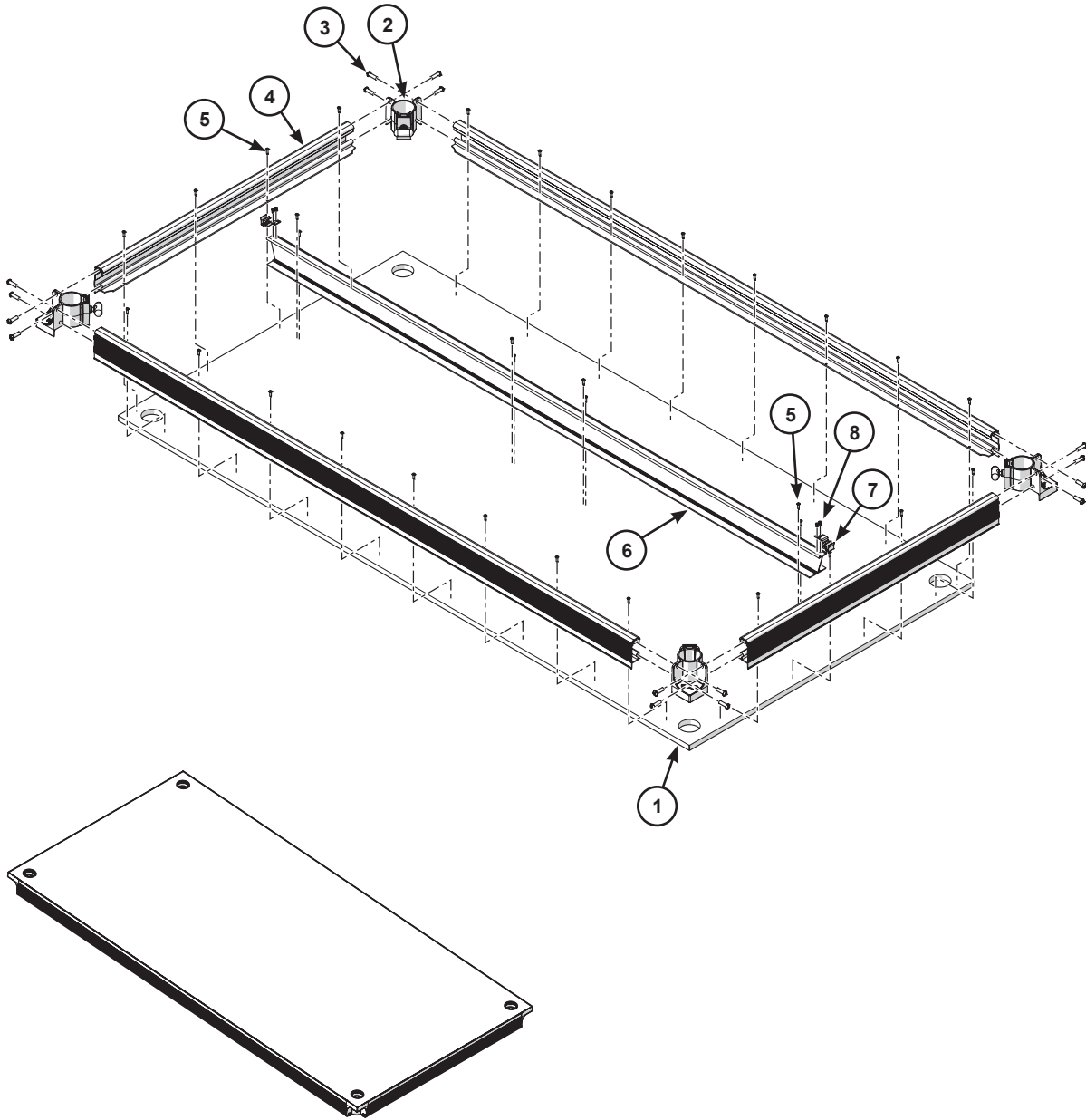

Part List (continued)

Approach Section

Item	Description	Item	Description
1	Bottom Approach Weldment	4	3/16" Blind Rivet
2	Top Approach Weldment	5	3/8-16 x 2-1/2" Leveler Glide
3	Glide Base	6	Transition Tape

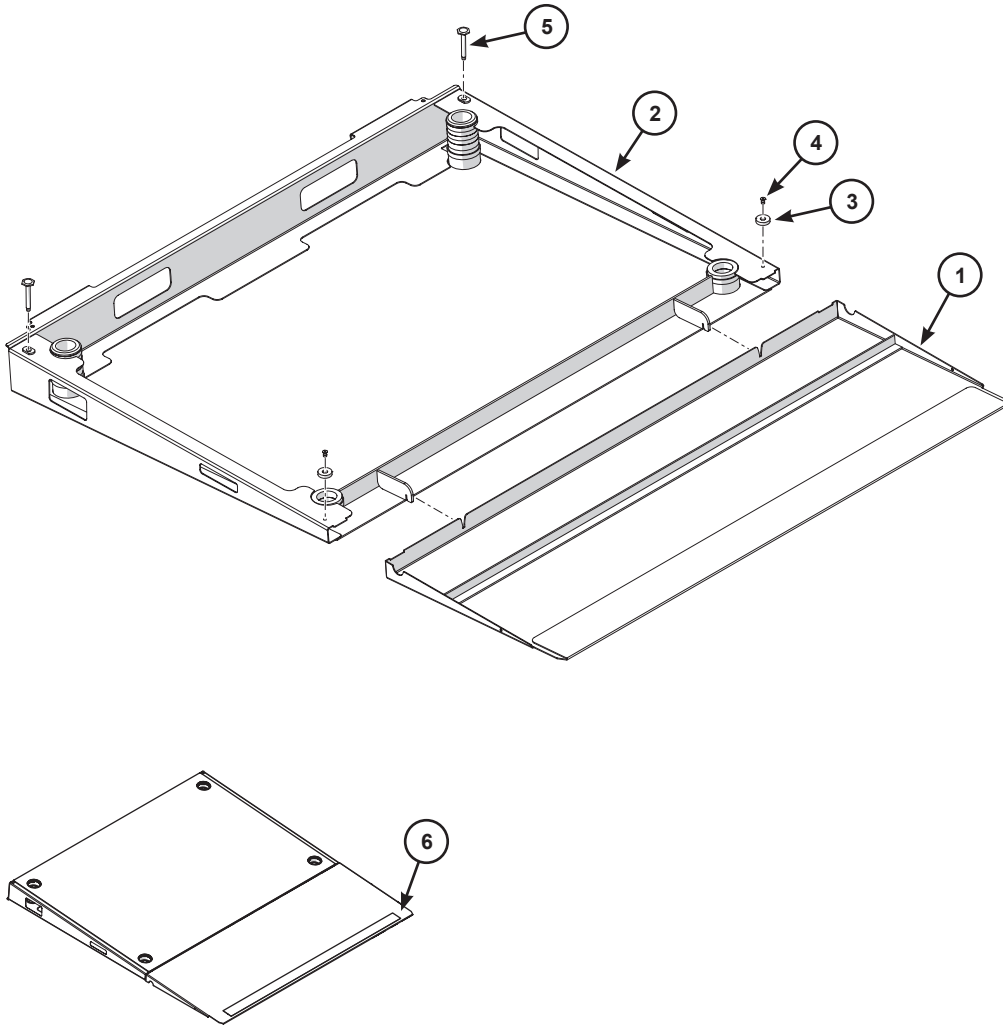

Part List (continued)

Connectors

Item	Description	Item	Description	Item	Description
1	Two Leg Deck Connector	2	Ramp to Deck Connector	3	Frame Deck Anchor

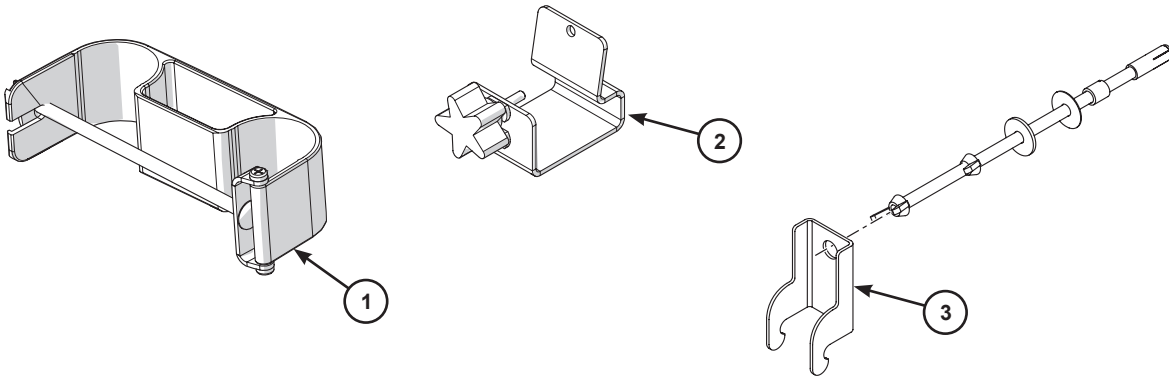

Legs

Item	Description	Item	Description
1	Flat Foot Leg	3	Leg without Insert
2	Swivel Foot Leg	4	Rail Pocket

